

N 1,457,000
E 697,000
N 1,449,000
N 1,441,000
N 1,433,000
E 709,000
E 721,000

REAL PROPERTY TAX MAP
 PREPARED FOR: SARATOGA COUNTY BOARD OF SUPERVISORS
 UNDER SUPERVISION OF: REAL PROPERTY TAX SERVICE AGENCY
 PREPARED BY: L. ROBERT KIMBALL CONSULTING ENGINEERS, ERENSBURG, PA (1973-1978)
 CONVERTED TO DIGITAL FORMAT BY THE L.A. GROUP, SARATOGA SPRINGS, NY (1996-1998)
 CONVERTED TO DIGITAL FORMAT FROM MAG 27 TO MAG 83 BY WIELER MAPPING, INC. (2002)
 CONVERTED TO ESRI GEDATABASE FORMAT BY FOUNTAINS SPATIAL, INC. (2007-2008)

MODULAR MAP BREAKDOWN

01	02	05	06	07	08
09	10	11	12	13	14
15	16	17	18	19	20

SCALE 1" = 400'
(800' x 1500')

SCALE 1" = 200'
(400' x 600')

SCALE 1" = 100'
(1600' x 2400')

LEGEND

COUNTY LINE	SECTION NUMBER (1" = 400')	STATE ROUTE
TOWN/VILLAGE/CITY	SECTION NUMBER (1" = 200')	COUNTY ROUTE
GREAT LOT LINE	SECTION NUMBER (1" = 100')	STREET OR TOWN ROAD
GREAT LOT NUMBER	SECTION NUMBER (1" = 50')	MAIN ST
PROPERTY LINE		STREAM OR DITCH

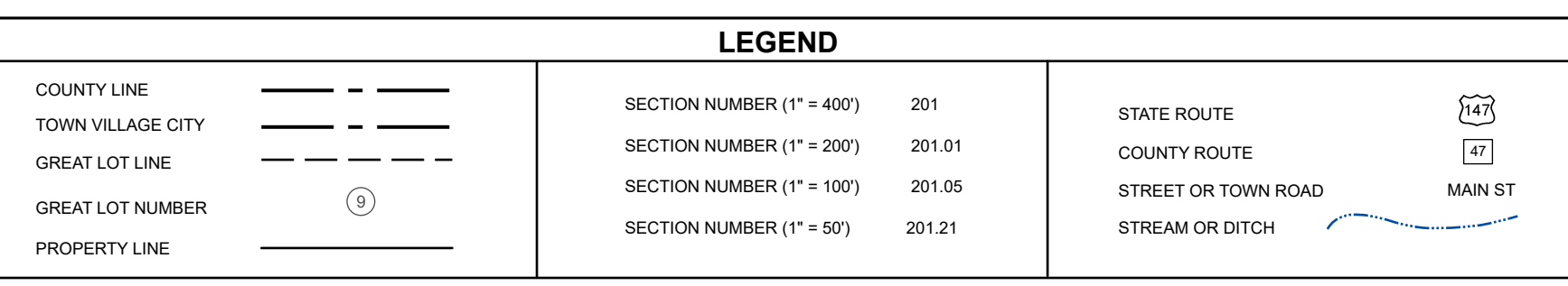

TOWN OF WATERFORD
SARATOGA COUNTY, NEW YORK
 TAXABLE STATUS DATE: MARCH 1, 2026

INDEX