

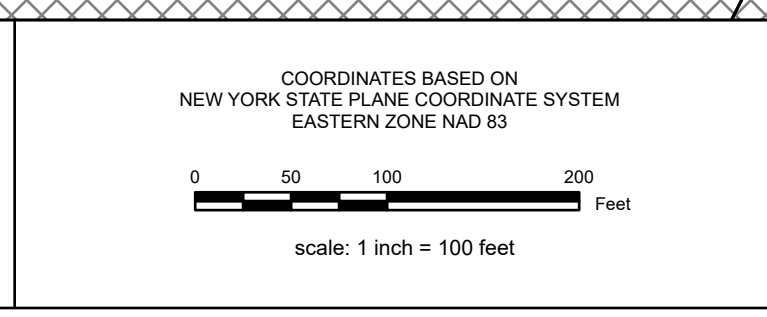

REAL PROPERTY TAX MAP
 PREPARED FOR: SARATOGA COUNTY BOARD OF SUPERVISORS
 UNDER SUPERVISION OF: REAL PROPERTY TAX SERVICE AGENCY
 PREPARED BY: L. ROBERT KIMBALL CONSULTING ENGINEERS, EBERSBURG, PA (1973-1978)
 CONVERTED TO DIGITAL FORMAT BY THE L.A. GROUP SARATOGA SPRINGS, NY (1986-1998)
 CONVERTED TO DIGITAL FORMAT FROM NAD 27 TO NAD 83 BY WILKER MAPPING, INC. (2002)
 CONVERTED TO ESRI GECODATABASE FORMAT BY FOUNTAINS SPITAL, INC. (2007-2008)

THIS MAP HAS BEEN PREPARED FROM MAPS AND DEEDS AND OTHER INFORMATION OF PUBLIC RECORD. IN ACCORDANCE WITH THE PROVISIONS OF THE REAL PROPERTY TAX LAW, FOR ASSESSMENT PURPOSES ONLY.
 IT DOES NOT REPRESENT A LAND SURVEY AND MUST NOT BE CONSTRUED AS SUCH.
 DESCRIPTIONS OF REAL PROPERTY TAKEN HEREFROM FOR THE PURPOSE OF CONVEYANCE OR TRANSFER, MUST BE LIMITED TO THOSE NECESSARY AND INCIDENTAL TO THE ADMINISTRATION OF THE REAL PROPERTY TAX LAW.



SPECIAL DISTRICTS	
SCHOOL: WATERFORD HALFBOON 45561	FIRE: NORTHSIDE FIRE #1 FD04
WATER: WATER BONDS #7019	FIRE PROTECTION #1 FD05
LIGHT: MOHAWK LIGHT LT03	LIGHT: NORTHSIDE LIGHT LT04
SEWER:	SEWER:
PARK:	PARK:

PROPERTY LINE	GREAT LOT LINE
BLOCK LIMIT	SUBDIVISION LOT LINE
SECTION LIMIT	STATE ROUTE
TOWN/VILLAGE/CITY	COUNTY ROUTE
COUNTY LINE	STREET OR TOWN ROAD
RAILROAD	MAIN ST

LEGEND	
SCHOOL DISTRICT LINE	GREAT LOT NUMBER
FIRE DISTRICT LINE	TAX MAP BLOCK NUMBER
WATER DISTRICT LINE	FILED PLAN LOT NUMBER
AGRICULTURAL DISTRICT	TAX MAP PARCEL NUMBER
LIGHT DISTRICT	STREAM/WATERBODY
NAD 83 TIC LINES	

CALCULATED ACREAGE	9.8 A (C)
DEED ACREAGE	8.8 A
SCALED DIMENSION	150.2
DEED DIMENSION	150.2
COORDINATE LOCATOR	
DENOTES COMMON OWNER	

TAX MAP 291.17
TOWN OF WATERFORD
 SARATOGA COUNTY, NEW YORK
 TAXABLE STATUS DATE: March 1, 2028 MAP EXPORTED ON: March 11, 2028