

ALBANY  
 MOHAWK  
 RIVER  
 COUNTY  
 ALBANY  
 MOHAWK

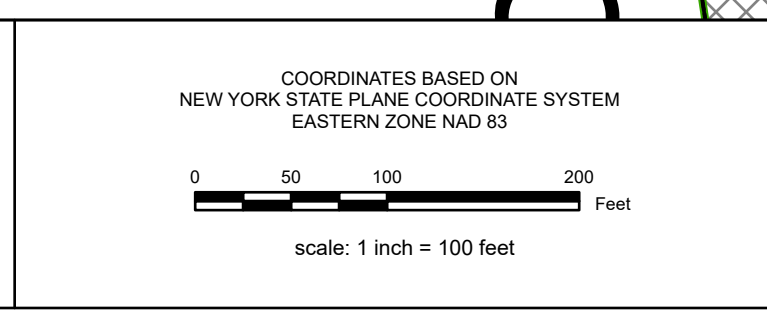

**REAL PROPERTY TAX MAP**  
 SARATOGA COUNTY BOARD OF SUPERVISORS  
 UNDER SUPERVISION OF: REAL PROPERTY TAX SERVICE AGENCY  
 PREPARED BY:  
 L. ROBERT KIMBALL CONSULTING ENGINEERS, EBENSBURG, PA (1973-1978)  
 CONVERTED TO DIGITAL FORMAT BY THE L.A. GROUP SARATOGA SPRINGS, NY (1986-1998)  
 CONVERTED TO DIGITAL FORMAT FROM NAD 27 TO NAD 83 BY WILDERMAPPING, INC. (2002)  
 CONVERTED TO ESRI GECODATABASE FORMAT BY FOUNTAINS SPATIAL, INC. (2007-2008)

THIS MAP HAS BEEN PREPARED FROM MAPS AND DEEDS AND OTHER INFORMATION OF PUBLIC RECORD. IN ACCORDANCE WITH THE PROVISIONS OF THE REAL PROPERTY TAX LAW, FOR ASSESSMENT PURPOSES ONLY.  
 IT DOES NOT REPRESENT A LAND SURVEY AND MUST NOT BE CONSTRUED AS SUCH.  
 DESCRIPTIONS OF REAL PROPERTY TAKEN HEREFROM FOR THE PURPOSE OF CONVEYANCE OR TRANSFER MUST BE LIMITED TO THOSE NECESSARY AND INCIDENTAL TO THE ADMINISTRATION OF THE REAL PROPERTY TAX LAW.



SPECIAL DISTRICTS	
<b>SCHOOL:</b> SHENDEKOWA 41242	<b>PIPE:</b> HALOON - WATERBORO FIRE FD06
<b>WATER:</b> WATER BODIES W709	<b>LIGHT:</b>
<b>AG:</b>	<b>SEWER:</b>
<b>LAKE:</b>	<b>PARK:</b>

LEGEND	
<b>PROPERTY LINE</b>	<b>GREAT LOT LINE</b>
<b>BLOCK LIMIT</b>	<b>SUBDIVISION LOT LINE</b>
<b>SECTION VILLAGE CITY</b>	<b>STATE ROUTE</b>
<b>COUNTY LINE</b>	<b>STREET OR TOWN ROAD</b>
<b>RAILROAD</b>	<b>SCHOOL DISTRICT LINE</b>
<b>FIRE DISTRICT LINE</b>	<b>WATER DISTRICT LINE</b>
<b>AGRICULTURAL DISTRICT</b>	<b>LIGHT DISTRICT</b>
<b>NAD 83 TIC LINES</b>	<b>+</b>

<b>GREAT LOT NUMBER</b>	<b>TAX MAP BLOCK NUMBER</b>	<b>DEED ACRES</b>	<b>8.8 A (C)</b>
<b>FILED PLAN LOT NUMBER</b>	<b>TAX MAP PARCEL NUMBER</b>	<b>150.2</b>	<b>8.8 A</b>
<b>STREAM/WATERBODY</b>	<b>DENOTES COMMON OWNER</b>	<b>150.2</b>	<b>150.2</b>

SHEET INDEX		
285.00	285.00	285.00
285.00	285.15	285.15
285.00	285.18	285.19

**TAX MAP 285.14**  
**TOWN OF WATERFORD**  
**SARATOGA COUNTY, NEW YORK**  
 TAXABLE STATUS DATE: March 1, 2028  
 MAP EXPORTED ON: March 11, 2028