

REAL PROPERTY TAX MAP
 PREPARED FOR: SARATOGA COUNTY BOARD OF SUPERVISORS
 UNDER SUPERVISION OF: REAL PROPERTY TAX SERVICE AGENCY
 PREPARED BY:
 L. ROBERT KIMBALL CONSULTING ENGINEERS, EBENSBURG, PA (1973-1978)
 CONVERTED TO DIGITAL FORMAT BY THE L.A. GROUP SARATOGA SPRINGS, NY (1986-1998)
 CONVERTED TO DIGITAL FORMAT FROM NAD 27 TO NAD 83 BY WILSON MAPPING, INC. (2002)
 CONVERTED TO ESRI GDB/DATABASE FORMAT BY FOUNTAINS SPATIAL, INC. (2007-2008)

THIS MAP HAS BEEN PREPARED FROM MAPS AND DEEDS AND OTHER INFORMATION OF PUBLIC RECORD, IN ACCORDANCE WITH THE PROVISIONS OF THE REAL PROPERTY TAX LAW, FOR ASSESSMENT PURPOSES ONLY.
 IT DOES NOT REPRESENT A LAND SURVEY AND MUST NOT BE CONSTRUED AS SUCH.
 DESCRIPTIONS OF REAL PROPERTY TAKEN HEREFROM FOR THE PURPOSE OF CONVEYANCE OR TRANSFER, MUST BE LIMITED TO THOSE NECESSARY AND INCIDENTAL TO THE ADMINISTRATION OF THE REAL PROPERTY TAX LAW.

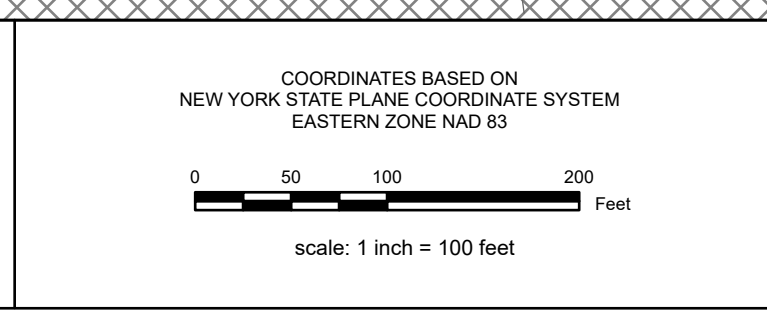

SPECIAL DISTRICTS	
AG: SARATOGA SPRINGS CITY SCHOOL 415500	LAKE:
SCHOOL: SARATOGA COUNTY DIST 1 010	WATER:
FIRE:	LIGHT:
	PARK:

PROPERTY LINE	
PROPERTY LINE	--- (solid line)
BLOCK LIMIT	--- (dashed line)
SECTION LIMIT	--- (dotted line)
TOWN/VILLAGE/CITY	--- (dash-dot line)
COUNTY LINE	--- (long-dash line)
RAILROAD	--- (cross-hatch line)

LEGEND	
GREAT LOT LINE	--- (solid line)
SUBDIVISION LOT LINE	--- (dashed line)
STATE ROUTE	--- (dotted line)
COUNTY ROUTE	--- (dash-dot line)
STREET OR TOWN ROAD	--- (long-dash line)
SCHOOL DISTRICT LINE	--- (cross-hatch line)
FIRE DISTRICT LINE	--- (cross-hatch line)
WATER DISTRICT LINE	--- (cross-hatch line)
AGRICULTURAL DISTRICT	--- (cross-hatch line)
LIGHT DISTRICT	--- (cross-hatch line)
NAD 83 TIC LINES	--- (cross-hatch line)
TAX MAP BLOCK NUMBER	①
FILED PLAN LOT NUMBER	①
TAX MAP PARCEL NUMBER	160.00-3.0
STREAM/WATERBODY	--- (wavy line)
DENOTES COMMON OWNER	--- (dotted line)

CALCULATED ACREAGE	
DEED ACREAGE	9.8 A (C)
SCALED DIMENSION	8.8 A
DEED DIMENSION	150.2
COORDINATE LOCATOR	160.00-3.0
DENOTES COMMON OWNER	--- (dotted line)

SHEET INDEX		
166.00	167.00	167.00
179.06	180.00	180.06
179.00	180.00	180.00

TAX MAP 180.05
CITY OF SARATOGA SPRINGS, NY
 SARATOGA COUNTY, NEW YORK
 TAXABLE STATUS DATE: March 1, 2020
 MAP EXPORTED ON: March 10, 2020