

REAL PROPERTY TAX MAP
 PREPARED FOR: SARATOGA COUNTY BOARD OF SUPERVISORS
 UNDER SUPERVISION OF: REAL PROPERTY TAX SERVICE AGENCY
 PREPARED BY: L. ROBERT KIMBALL CONSULTING ENGINEERS, EBENSBURG, PA (1973-1978)
 CONVERTED TO DIGITAL FORMAT BY THE L.A. GROUP SARATOGA SPRINGS, NY (1986-1998)
 CONVERTED TO DIGITAL FORMAT FROM NAD 27 TO NAD 83 BY WILKER MAPPING, INC. (2002)
 CONVERTED TO ESRI GEODATABASE FORMAT BY FOUNTAINS SPITAL, INC. (2007-2008)

THIS MAP HAS BEEN PREPARED FROM MAPS AND DEEDS AND OTHER INFORMATION OF PUBLIC RECORD, IN ACCORDANCE WITH THE PROVISIONS OF THE REAL PROPERTY TAX LAW, FOR ASSESSMENT PURPOSES ONLY.
 IT DOES NOT REPRESENT A LAND SURVEY AND MUST NOT BE CONSTRUED AS SUCH.
 DESCRIPTIONS OF REAL PROPERTY TAKEN HEREFROM FOR THE PURPOSE OF CONVEYANCE OR TRANSFER MUST BE LIMITED TO THOSE NECESSARY AND INCIDENTAL TO THE ADMINISTRATION OF THE REAL PROPERTY TAX LAW.

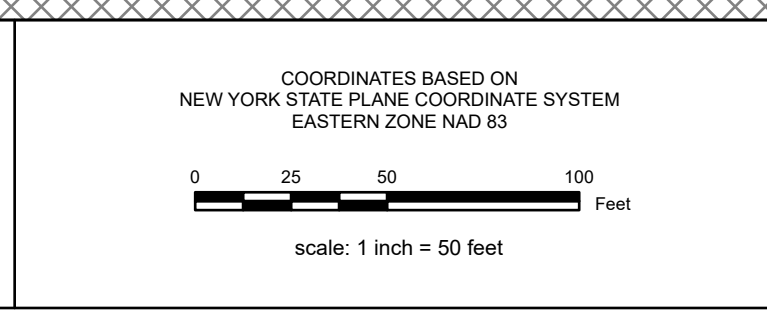

SPECIAL DISTRICTS

SCHOOL: SARATOGA SPRINGS CITY SCH DIST #12350	SEWER: SARATOGA CO. DIST. 1 50010
AG:	LIGHT:
FIRE:	PARK:
LAKE:	WATER:

PROPERTY LINE

PROPERTY LINE	GREAT LOT LINE
BLOCK LIMIT	SUBDIVISION LOT LINE
SECTION LIMIT	STATE ROUTE
TOWN/VILLAGE/CITY	STREET OR TOWN ROAD
COUNTY LINE	MAIN ST
RAILROAD	

LEGEND

SCHOOL DISTRICT LINE	FIRE DISTRICT LINE	WATER DISTRICT LINE	AGRICULTURAL DISTRICT	LIGHT DISTRICT	NAD 83 TIC LINES
GREAT LOT NUMBER	TAX MAP BLOCK NUMBER	FILED PLAN LOT NUMBER	TAX MAP PARCEL NUMBER	STREAM/WATERBODY	DENOTES COMMON OWNER

COORDINATE LOCATOR

COORDINATE LOCATOR	DENOTES COMMON OWNER
--------------------	----------------------

SHEET INDEX

178.00	178.00	178.00
178.00	178.34	178.34
178.00	178.00	178.00

TAX MAP 178.33
CITY OF SARATOGA SPRINGS ID
SARATOGA COUNTY, NEW YORK
 TAXABLE STATUS DATE: March 1, 2026
 MAP EXPORTED ON: March 19, 2026