

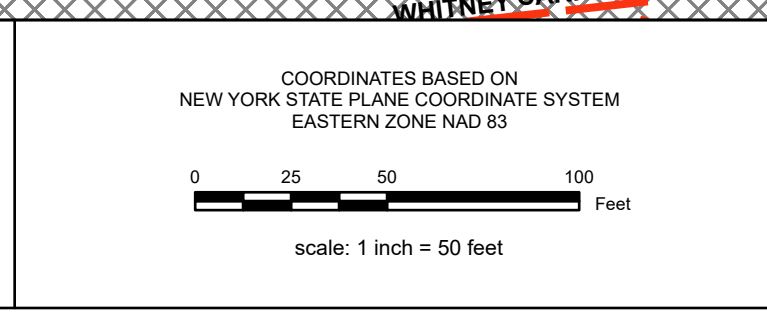

**REAL PROPERTY TAX MAP**  
 SARATOGA COUNTY BOARD OF SUPERVISORS  
 UNDER SUPERVISION OF: REAL PROPERTY TAX SERVICE AGENCY  
 PREPARED BY:  
 L. ROBERT KIMBALL CONSULTING ENGINEERS, EBENSBURG, PA (1973-1978)  
 CONVERTED TO DIGITAL FORMAT BY THE L.A. GROUP SARATOGA SPRINGS, NY (1986-1998)  
 CONVERTED TO DIGITAL FORMAT FROM NAD 27 TO NAD 83 BY WILSON MAPPING, INC. (2002)  
 CONVERTED TO ESRI GECODATABASE FORMAT BY FOUNTAINS SPATIAL, INC. (2007-2008)

THIS MAP HAS BEEN PREPARED FROM MAPS AND DEEDS AND OTHER INFORMATION OF PUBLIC RECORD. IN ACCORDANCE WITH THE PROVISIONS OF THE REAL PROPERTY TAX LAW, FOR ASSESSMENT PURPOSES ONLY.  
 IT DOES NOT REPRESENT A LAND SURVEY AND MUST NOT BE CONSTRUED AS SUCH.  
 DESCRIPTIONS OF REAL PROPERTY TAKEN HEREFROM FOR THE PURPOSE OF CONVEYANCE OR TRANSFER MUST BE LIMITED TO THOSE NECESSARY AND INCIDENTAL TO THE ADMINISTRATION OF THE REAL PROPERTY TAX LAW.



SPECIAL DISTRICTS	
SCHOOL: SARATOGA SPRINGS CITY 901 DIST #12350	SEWER: SARATOGA CO. DIST. 1 56510
AG:	LIGHT:
FIRE:	PARK:
LAKE:	WATER:

PROPERTY LINE	
BLOCK LIMIT	GREAT LOT LINE
SECTION LIMIT	SUBDIVISION LOT LINE
TOWN/VILLAGE/CITY	STATE ROUTE
COUNTY LINE	COUNTY ROUTE
RAILROAD	STREET OR TOWN ROAD

LEGEND	
SCHOOL DISTRICT LINE	FIRE DISTRICT LINE
WATER DISTRICT LINE	AGRICULTURAL DISTRICT
LIGHT DISTRICT	NAD 83 TIC LINES

GREAT LOT NUMBER	TAX MAP BLOCK NUMBER	FILED PLAN LOT NUMBER	TAX MAP PARCEL NUMBER	STREAM/WATERBODY
------------------	----------------------	-----------------------	-----------------------	------------------

CALCULATED ACREAGE	
DEED ACREAGE	9.8 A (C)
SCALED DIMENSION	9.8 A
DEED DIMENSION	150 (S)
COORDINATE LOCATOR	150.2
DENOTES COMMON OWNER	

**TAX MAP 166.53c-3**  
**CITY OF SARATOGA SPRINGS ID**  
 SARATOGA COUNTY, NEW YORK  
 TAXABLE STATUS DATE: March 1, 2026  
 MAP EXPORTED ON: March 19, 2026