

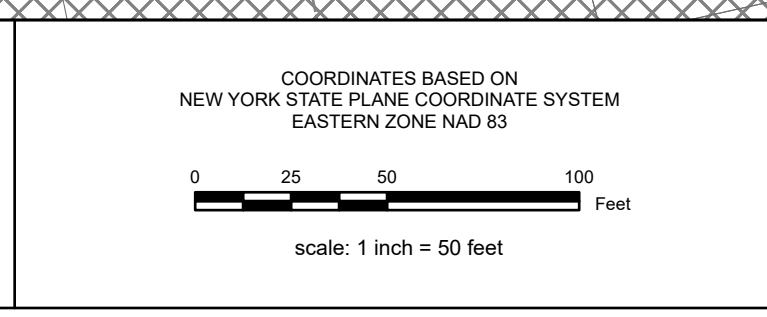

**REAL PROPERTY TAX MAP**  
 PREPARED FOR: SARATOGA COUNTY BOARD OF SUPERVISORS  
 UNDER SUPERVISION OF: REAL PROPERTY TAX SERVICE AGENCY  
 PREPARED BY: L. ROBERT KIMBALL CONSULTING ENGINEERS, EBERSBURG, PA (1973-1978)  
 CONVERTED TO DIGITAL FORMAT BY THE L.L. GROUP SARATOGA SPRINGS, NY (1986-1998)  
 CONVERTED TO DIGITAL FORMAT FROM NAD 27 TO NAD 83 BY WILKINS MAPPING, INC. (2002)  
 CONVERTED TO ESRI GDB/DATABASE FORMAT BY FOUNTAINS SPATIAL, INC. (2007-2008)

THIS MAP HAS BEEN PREPARED FROM MAPS AND DEEDS AND OTHER INFORMATION OF PUBLIC RECORD. IN ACCORDANCE WITH THE PROVISIONS OF THE REAL PROPERTY TAX LAW, FOR ASSESSMENT PURPOSES ONLY.  
 IT DOES NOT REPRESENT A LAND SURVEY AND MUST NOT BE CONSTRUED AS SUCH.  
 DESCRIPTIONS OF REAL PROPERTY TAKEN HEREFROM FOR THE PURPOSE OF CONVEYANCE OR TRANSFER, MUST BE LIMITED TO THOSE NECESSARY AND INCIDENTAL TO THE ADMINISTRATION OF THE REAL PROPERTY TAX LAW.



**SPECIAL DISTRICTS**

<b>SCHOOL:</b> SARATOGA SPRINGS CITY SCH DIST #12350	<b>SEWER:</b> SARATOGA CO. DIST. 1 5000
<b>AG:</b>	<b>LIGHT:</b>
<b>FIRE:</b>	<b>PARK:</b>
<b>LAKE:</b>	<b>WATER:</b>

**LEGEND**

PROPERTY LINE	GREAT LOT LINE	SCHOOL DISTRICT LINE	GREAT LOT NUMBER
BLOCK LIMIT	SUBDIVISION LOT LINE	FIRE DISTRICT LINE	TAX MAP BLOCK NUMBER
SECTION LIMIT	STATE ROUTE	WATER DISTRICT LINE	FILED PLAN LOT NUMBER
TOWN/VILLAGE/CITY	COUNTY ROUTE	AGRICULTURAL DISTRICT	TAX MAP PARCEL NUMBER
COUNTY LINE	STREET OR TOWN ROAD	LIGHT DISTRICT	COORDINATE LOCATOR
RAILROAD		NAD 83 TIC LINES	IDENTIFIES COMMON OWNER

165.44	166.37	166.38
165.52	166.45	166.46
165.60	166.53	166.54

**TAX MAP 166.45**  
**CITY OF SARATOGA SPRINGS ID**  
 SARATOGA COUNTY, NEW YORK  
 TAXABLE STATUS DATE: March 1, 2026  
 MAP EXPORTED ON: March 19, 2026

165.44	166.37	166.38
165.52	166.45	166.46
165.60	166.53	166.54

SHEET INDEX