

REAL PROPERTY TAX MAP
 PREPARED FOR: SARATOGA COUNTY BOARD OF SUPERVISORS
 UNDER SUPERVISION OF: REAL PROPERTY TAX SERVICE AGENCY
 PREPARED BY:
 L. ROBERT KIMBALL CONSULTING ENGINEERS, EBENSBURG, PA (1973-1978)
 CONVERTED TO DIGITAL FORMAT BY THE L.A. GROUP SARATOGA SPRINGS, NY (1996-1998)
 CONVERTED TO DIGITAL FORMAT FROM NAD 27 TO NAD 83 BY WELLES-MAPPING, INC. (2002)
 CONVERTED TO ESRI GECODATABASE FORMAT BY FOUNTAINS SPATIAL, INC. (2007-2008)

THIS MAP HAS BEEN PREPARED FROM MAPS AND DEEDS AND OTHER INFORMATION OF PUBLIC RECORD, IN ACCORDANCE WITH THE PROVISIONS OF THE REAL PROPERTY TAX LAW, FOR ASSESSMENT PURPOSES ONLY.
 IT DOES NOT REPRESENT A LAND SURVEY AND MUST NOT BE CONSTRUED AS SUCH.
 DESCRIPTIONS OF REAL PROPERTY TAKEN HEREFROM FOR THE PURPOSE OF CONVEYANCE OR TRANSFER, MUST BE LIMITED TO THOSE NECESSARY AND INCIDENTAL TO THE ADMINISTRATION OF THE REAL PROPERTY TAX LAW.

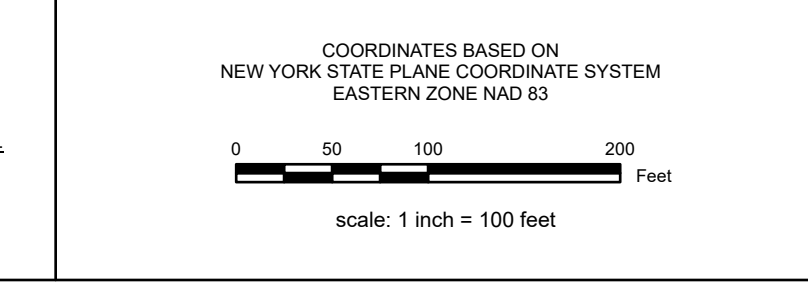

SPECIAL DISTRICTS

SCHOOL: SARATOGA SPRINGS CITY SCH DIST #12350	SEWER: SARATOGA CO. DIST 1 56930
AG:	LIGHT:
FIRE:	PARK:
LAKE:	WATER:

PROPERTY LINE

BLOCK LIMIT	---+---
SECTION LIMIT	---+---
TOWN VILLAGE CITY	---+---
COUNTY LINE	---+---
RAILROAD	---+---

LEGEND

GREAT LOT LINE	---
SUBDIVISION LOT LINE	---
STATE ROUTE	---
STREET OR TOWN ROAD	---
SCHOOL DISTRICT LINE	---
FIRE DISTRICT LINE	---
WATER DISTRICT LINE	---
AGRICULTURAL DISTRICT	---
LIGHT DISTRICT	---
NAD 83 TIC LINES	---
TAX MAP BLOCK NUMBER	---
FILED PLAN LOT NUMBER	---
TAX MAP PARCEL NUMBER	---
STREAM/WATERBODY	---

GREAT LOT NUMBER
 TAX MAP BLOCK NUMBER
 FILED PLAN LOT NUMBER
 TAX MAP PARCEL NUMBER
 STREAM/WATERBODY

CALCULATED ACREAGE
 DEED ACREAGE
 SCALED DIMENSION
 DEED DIMENSION
 COORDINATE LOCATOR
 DENOTES COMMON OWNER

TAX MAP 166.15

CITY OF SARATOGA SPRINGS ID

SARATOGA COUNTY, NEW YORK

TAXABLE STATUS DATE: March 1, 2026 MAP EXPORTED ON: March 19, 2026

TAX MAP 166.15

CITY OF SARATOGA SPRINGS ID

SARATOGA COUNTY, NEW YORK

TAXABLE STATUS DATE: March 1, 2026 MAP EXPORTED ON: March 19, 2026