

REAL PROPERTY TAX MAP
 PREPARED FOR: SARATOGA COUNTY BOARD OF SUPERVISORS
 UNDER SUPERVISION OF: REAL PROPERTY TAX SERVICE AGENCY
 PREPARED BY: L. ROBERT KIMBALL CONSULTING ENGINEERS, ERIENBURG, PA (1973-1978)
 CONVERTED TO DIGITAL FORMAT BY THE L.A. GROUP SARATOGA SPRINGS, NY (1998-1999)
 CONVERTED TO DIGITAL FORMAT FROM NAD 27 TO NAD 83 BY WILDER MAPPING, INC. (2002)
 CONVERTED TO ESRI GECODATABASE FORMAT BY FOUNTAINS SPATIAL, INC. (2007-2008)

THIS MAP HAS BEEN PREPARED FROM MAPS AND DEEDS AND OTHER INFORMATION OF PUBLIC RECORD. IN ACCORDANCE WITH THE PROVISIONS OF THE REAL PROPERTY TAX LAW, FOR ASSESSMENT PURPOSES ONLY.
 IT DOES NOT REPRESENT A LAND SURVEY AND MUST NOT BE CONSTRUED AS SUCH.
 DESCRIPTIONS OF REAL PROPERTY TAKEN HEREFROM FOR THE PURPOSE OF CONVEYANCE OR TRANSFER MUST BE LIMITED TO THOSE NECESSARY AND INCIDENTAL TO THE ADMINISTRATION OF THE REAL PROPERTY TAX LAW.

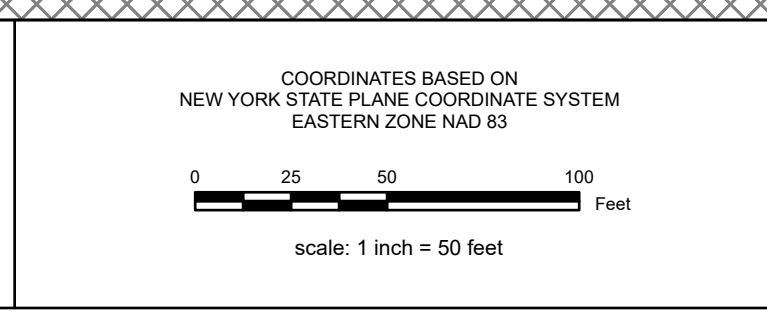

SPECIAL DISTRICTS	
SCHOOL: SARATOGA SPRINGS CITY 901 DIST #12350	SEWER: SARATOGA CO. DIST. 1 50010
AG:	LIGHT:
FIRE:	PARK:
LAKE:	WATER:

PROPERTY LINE	
BLOCK LIMIT	SECTION LIMIT
TOWN/VILLAGE/CITY	COUNTY LINE
RAILROAD	

LEGEND	
GREAT LOT LINE	SCHOOL DISTRICT LINE
SUBDIVISION LOT LINE	FIRE DISTRICT LINE
STATE ROUTE	WATER DISTRICT LINE
COUNTY ROUTE	AGRICULTURAL DISTRICT
STREET OR TOWN ROAD	LIGHT DISTRICT
	NAD 83 TIC LINES

GREAT LOT NUMBER	TAX MAP BLOCK NUMBER
FILED PLAN LOT NUMBER	TAX MAP PARCEL NUMBER
STREAM/WATERBODY	

CALCULATED ACREAGE	
DEED ACREAGE	S.S.A. (C)
SCALED DIMENSION	S.S.A. (A)
DEED DIMENSION	150 (S)
COORDINATE LOCATOR	150.2
DENOTES COMMON OWNER	

TAX MAP 165.52c-3
CITY OF SARATOGA SPRINGS ID
 SARATOGA COUNTY, NEW YORK
 TAXABLE STATUS DATE: March 1, 2026
 MAP EXPORTED ON: March 19, 2026