

REAL PROPERTY TAX MAP
 PREPARED FOR: SARATOGA COUNTY BOARD OF SUPERVISORS
 UNDER SUPERVISION OF: REAL PROPERTY TAX SERVICE AGENCY

THIS MAP HAS BEEN PREPARED FROM MAPS AND DEEDS AND OTHER INFORMATION OF PUBLIC RECORD, IN ACCORDANCE WITH THE PROVISIONS OF THE REAL PROPERTY TAX LAW, FOR ASSESSMENT PURPOSES ONLY.
 IT DOES NOT REPRESENT A LAND SURVEY AND MUST NOT BE CONSTRUED AS SUCH.
 DESCRIPTIONS OF REAL PROPERTY TAKEN HEREFROM FOR THE PURPOSE OF CONVEYANCE OR TRANSFER MUST BE LIMITED TO THOSE NECESSARY AND INCIDENTAL TO THE ADMINISTRATION OF THE REAL PROPERTY TAX LAW.

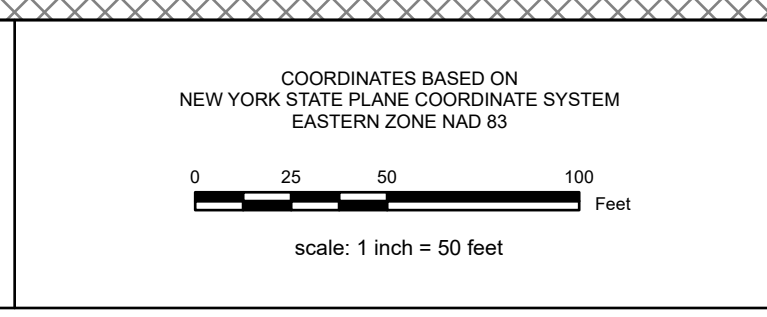

SPECIAL DISTRICTS	
AG:	LAKE:
FIRE:	WATER:
SCHOOL: SCHUYLERVILLE CENTRAL (1030)	LIGHT:
SEWER:	PARK:

PROPERTY LINE	GREAT LOT LINE	SCHOOL DISTRICT LINE	GREAT LOT NUMBER
BLOCK LIMIT	SUBDIVISION LOT LINE	FIRE DISTRICT LINE	TAX MAP BLOCK NUMBER
SECTION LIMIT	STATE ROUTE	WATER DISTRICT LINE	FILED PLAN LOT NUMBER
TOWN/VILLAGE/CITY	COUNTY ROUTE	AGRICULTURAL DISTRICT	TAX MAP PARCEL NUMBER
COUNTY LINE	STREET OR TOWN ROAD	LIGHT DISTRICT	STREAM/WATERBODY
RAILROAD	MAIN ST	NAD 83 TIC LINES	DENOTES COMMON OWNER

LEGEND	
156.00	V157.69
156.00	V157.70
169.00	170.00
170.00	170.00

TAX MAP **VILLAGE OF VICTORY** **V157.77**
 SARATOGA COUNTY, NEW YORK
 TAXABLE STATUS DATE: March 1, 2028 MAP EXPORTED ON: March 11, 2028