

REAL PROPERTY TAX MAP
 PREPARED FOR: SARATOGA COUNTY BOARD OF SUPERVISORS
 UNDER SUPERVISION OF: REAL PROPERTY TAX SERVICE AGENCY
 PREPARED BY:
 L. ROBERT KIMBALL CONSULTING ENGINEERS, EBENSBURG, PA (1973-1978)
 CONVERTED TO DIGITAL FORMAT BY THE L.G. GROUP SARATOGA SPRINGS, NY (1986-1998)
 CONVERTED TO DIGITAL FORMAT FROM NAD 27 TO NAD 83 BY WILSON MAPPING, INC. (2002)
 CONVERTED TO ESRI GDB/DATABASE FORMAT BY FOUNTAINS SPITAL, INC. (2007-2008)

THIS MAP HAS BEEN PREPARED FROM MAPS AND DEEDS AND OTHER INFORMATION OF PUBLIC RECORD. IN ACCORDANCE WITH THE PROVISIONS OF THE REAL PROPERTY TAX LAW, FOR ASSESSMENT PURPOSES ONLY.
 IT DOES NOT REPRESENT A LAND SURVEY AND MUST NOT BE CONSTRUED AS SUCH.
 DESCRIPTIONS OF REAL PROPERTY TAKEN HEREFROM FOR THE PURPOSE OF CONVEYANCE OR TRANSFER, MUST BE LIMITED TO THOSE NECESSARY AND INCIDENTAL TO THE ADMINISTRATION OF THE REAL PROPERTY TAX LAW.

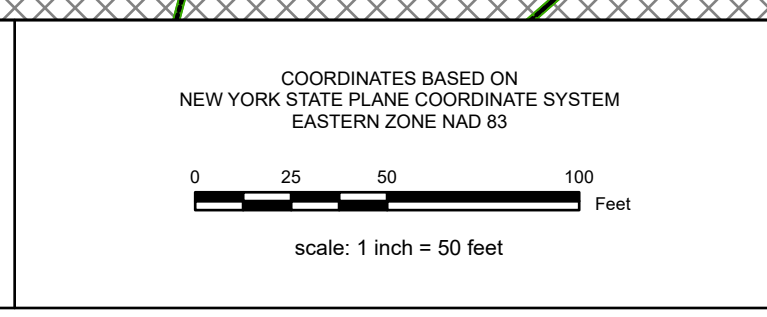

| SPECIAL DISTRICTS | |
|--------------------------------------|--------|
| AG: | LAKE: |
| FIRE: | WATER: |
| SCHOOL: SCHUYLERVILLE CENTRAL (4180) | LIGHT: |
| SEWER: | PARK: |

| PROPERTY LINE | |
|-------------------|----------------------|
| BLOCK LIMIT | GREAT LOT LINE |
| SECTION LIMIT | SUBDIVISION LOT LINE |
| TOWN/VILLAGE CITY | STATE ROUTE |
| COUNTY LINE | STREET OR TOWN ROAD |
| RAILROAD | MAIN ST |

| LEGEND | |
|-----------------------|---|
| SCHOOL DISTRICT LINE | + |
| FIRE DISTRICT LINE | + |
| WATER DISTRICT LINE | + |
| AGRICULTURAL DISTRICT | + |
| LIGHT DISTRICT | + |
| NAD 83 TIC LINES | + |

| | | | |
|-----------------------|---|----------------------|-----------|
| GREAT LOT NUMBER | ○ | CALCULATED ACREAGE | 8.8 A (C) |
| TAX MAP BLOCK NUMBER | ① | DEED ACREAGE | 8.8 A |
| FILED PLAN LOT NUMBER | ② | SCALED DIMENSION | 150 (S) |
| TAX MAP PARCEL NUMBER | ③ | DEED DIMENSION | 150.2 |
| STREAM/WATERBODY | + | COORDINATE LOCATOR | + |
| | | DENOTES COMMON OWNER | + |

| SHEET INDEX | | |
|-------------|--------|--------|
| 157.00 | 157.00 | 157.00 |
| 157.70 | 157.70 | 157.72 |
| 157.00 | 157.00 | 157.00 |

TAX MAP S157.71
VILLAGE OF SCHUYLERVILLE
 SARATOGA COUNTY, NEW YORK
 TAXABLE STATUS DATE: March 1, 2028
 MAP EXPORTED ON: March 09, 2028