

REAL PROPERTY TAX MAP
 PREPARED FOR: SARATOGA COUNTY BOARD OF SUPERVISORS
 UNDER SUPERVISION OF: REAL PROPERTY TAX SERVICE AGENCY
 PREPARED BY:
 L. ROBERT KIMBALL CONSULTING ENGINEERS, EBENSBURG, PA (1973-1978)
 CONVERTED TO DIGITAL FORMAT BY THE L.A. GROUP SARATOGA SPRINGS, NY (1986-1998)
 CONVERTED TO DIGITAL FORMAT FROM NAD 27 TO NAD 83 BY WELLS MAPPING, INC. (2002)
 CONVERTED TO ESRI GECODATABASE FORMAT BY FOUNTAINS SPATIAL, INC. (2007-2008)

THIS MAP HAS BEEN PREPARED FROM MAPS AND DEEDS AND OTHER INFORMATION OF PUBLIC RECORD, IN ACCORDANCE WITH THE PROVISIONS OF THE REAL PROPERTY TAX LAW, FOR ASSESSMENT PURPOSES ONLY.
 IT DOES NOT REPRESENT A LAND SURVEY AND MUST NOT BE CONSTRUED AS SUCH.
 DESCRIPTIONS OF REAL PROPERTY TAKEN HEREFROM FOR THE PURPOSE OF CONVEYANCE OR TRANSFER MUST BE LIMITED TO THOSE NECESSARY AND INCIDENTAL TO THE ADMINISTRATION OF THE REAL PROPERTY TAX LAW.

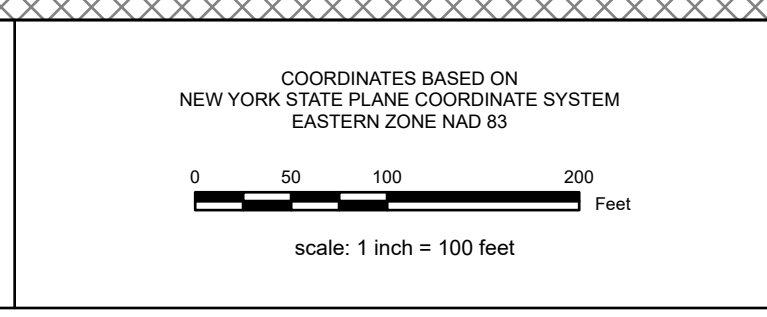

SPECIAL DISTRICTS	
AG: CONSOLIDATED DIST 1 AG001	LAKE:
FIRE: QUAKER SPRINGS FIRE F0003	WATER:
SCHOOL: STILLWATER CENTRAL 415001	LIGHT:
SEWER:	PARK:

PROPERTY LINE	
BLOCK LIMIT	GREAT LOT LINE
SECTION LIMIT	SUBDIVISION LOT LINE
TOWN VILLAGE CITY	STATE ROUTE
COUNTY LINE	COUNTY ROUTE
RAILROAD	STREET OR TOWN ROAD
	MAIN ST

LEGEND	
SCHOOL DISTRICT LINE	AGRICULTURAL DISTRICT
FIRE DISTRICT LINE	LIGHT DISTRICT
WATER DISTRICT LINE	NAD 83 TIC LINES
AGRICULTURAL DISTRICT	
LIGHT DISTRICT	
NAD 83 TIC LINES	

GREAT LOT NUMBER	1	9.8 A (C)
TAX MAP BLOCK NUMBER	0	8.5 A
FILED PLAN LOT NUMBER	0	150 (S)
TAX MAP PARCEL NUMBER	160.00-3-9	150.2
STREAMWATERBODY		COORDINATE LOCATOR
		DENOTES COMMON OWNER

SHEET INDEX	
208.00	209.00
208.00	209.00

TAX MAP **209.09**
TOWN OF SARATOGA
 SARATOGA COUNTY, NEW YORK
 TAXABLE STATUS DATE: March 1, 2028 MAP EXPORTED ON: March 12, 2028