

**REAL PROPERTY TAX MAP**  
 PREPARED FOR: SARATOGA COUNTY BOARD OF SUPERVISORS  
 UNDER SUPERVISION OF: REAL PROPERTY TAX SERVICE AGENCY  
 PREPARED BY:  
 L. ROBERT KIMBALL CONSULTING ENGINEERS, EBENSBURG, PA (1973-1978)  
 CONVERTED TO DIGITAL FORMAT BY THE L.A. GROUP SARATOGA SPRINGS, NY (1986-1998)  
 CONVERTED TO DIGITAL FORMAT FROM NAD 27 TO NAD 83 BY WILSON MAPPING, INC. (2002)  
 CONVERTED TO ESRI GECODATABASE FORMAT BY FOUNTAINS SPITAL, INC. (2007-2008)

THIS MAP HAS BEEN PREPARED FROM MAPS AND DEEDS AND OTHER INFORMATION OF PUBLIC RECORD. IN ACCORDANCE WITH THE PROVISIONS OF THE REAL PROPERTY TAX LAW, FOR ASSESSMENT PURPOSES ONLY.  
 IT DOES NOT REPRESENT A LAND SURVEY AND MUST NOT BE CONSTRUED AS SUCH.  
 DESCRIPTIONS OF REAL PROPERTY TAKEN HEREFROM FOR THE PURPOSE OF CONVEYANCE OR TRANSFER MUST BE LIMITED TO THOSE NECESSARY AND INCIDENTAL TO THE ADMINISTRATION OF THE REAL PROPERTY TAX LAW.

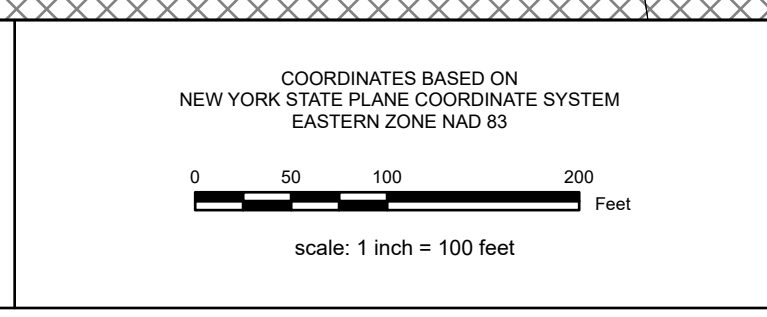

| SPECIAL DISTRICTS                                 |               |
|---|---------------|
| <b>AG:</b>  | <b>LAKE:</b>  |
| <b>FIRE:</b> NORTHUMBERLAND/SHENKSTOWN FIRE FD027 | <b>WATER:</b> |
| <b>SCHOOL:</b> SCHUYLVILLE CENTRAL 41501          | <b>LIGHT:</b> |
| <b>SEWER:</b>                                     | <b>PARK:</b>  |

| PROPERTY LINE     |                      |
|-------------------|----------------------|
| BLOCK LIMIT       | GREAT LOT LINE       |
| SECTION LIMIT     | SUBDIVISION LOT LINE |
| TOWN/VILLAGE/CITY | STATE ROUTE          |
| COUNTY LINE       | STREET OR TOWN ROAD  |
| RAILROAD          | MAIN ST              |

| LEGEND                |   |
|-----------------------|---|
| SCHOOL DISTRICT LINE  | + |
| FIRE DISTRICT LINE    | + |
| WATER DISTRICT LINE   | + |
| AGRICULTURAL DISTRICT | + |
| LIGHT DISTRICT        | + |
| NAD 83 TIC LINES      | + |

|                       |   |                         |           |
|-----------------------|---|-------------------------|-----------|
| GREAT LOT NUMBER      | ① | CALCULATED ACREAGE      | 9.8 A (C) |
| TAX MAP BLOCK NUMBER  | ② | DEED ACREAGE            | 8.8 A     |
| FILED PLAN LOT NUMBER | ③ | SCALED DIMENSION        | 150 (S)   |
| TAX MAP PARCEL NUMBER | ④ | DEED DIMENSION          | 150.2     |
| STREAM/WATERBODY      | ⑤ | COORDINATE LOCATOR      | +         |
|                       |   | IDENTIFIES COMMON OWNER | +         |

| SHEET INDEX |        |        |
|-------------|--------|--------|
| 116.18      | 116.19 | 116.20 |
| 129.06      | 129.07 | 129.08 |
| 129.00      | 129.00 | 129.00 |

**TAX MAP** 129.07  
**TOWN OF NORTHUMBERLAND**  
 SARATOGA COUNTY, NEW YORK  
 TAXABLE STATUS DATE: March 1, 2028 MAP EXPORTED ON: March 20, 2028