

**REAL PROPERTY TAX MAP**  
 PREPARED FOR: SARATOGA COUNTY BOARD OF SUPERVISORS  
 UNDER SUPERVISION OF: REAL PROPERTY TAX SERVICE AGENCY  
 PREPARED BY:  
 L. ROBERT KIMBALL CONSULTING ENGINEERS, EBENSBURG, PA (1973-1978)  
 CONVERTED TO DIGITAL FORMAT BY THE L.A. GROUP SARATOGA SPRINGS, NY (1986-1998)  
 CONVERTED TO DIGITAL FORMAT FROM NAD 27 TO NAD 83 BY WILSON MAPPING, INC. (2002)  
 CONVERTED TO ESRI GDB/DATABASE FORMAT BY FOUNTAINS SPATIAL, INC. (2007-2008)

THIS MAP HAS BEEN PREPARED FROM MAPS AND DEEDS AND OTHER INFORMATION OF PUBLIC RECORD. IN ACCORDANCE WITH THE PROVISIONS OF THE REAL PROPERTY TAX LAW, FOR ASSESSMENT PURPOSES ONLY.  
 IT DOES NOT REPRESENT A LAND SURVEY AND MUST NOT BE CONSTRUED AS SUCH.  
 DESCRIPTIONS OF REAL PROPERTY TAKEN HEREFROM FOR THE PURPOSE OF CONVEYANCE OR TRANSFER MUST BE LIMITED TO THOSE NECESSARY AND INCIDENTAL TO THE ADMINISTRATION OF THE REAL PROPERTY TAX LAW.

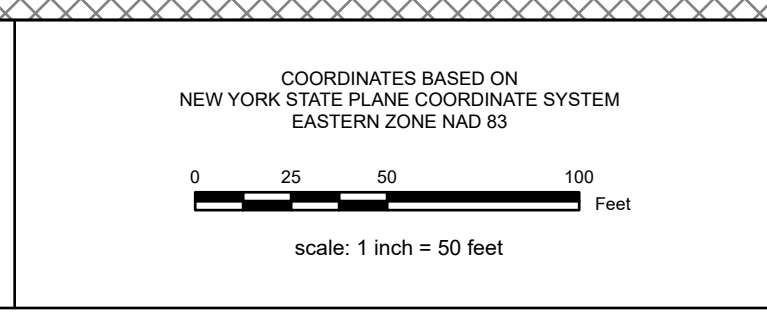

SPECIAL DISTRICTS	
<b>SCHOOL:</b> SOUTH GLENS FALLS CENTRAL 414402	<b>LIGHT:</b>
<b>FIRE:</b>	<b>WATER:</b>
<b>AG:</b>	<b>PARK:</b>
<b>SEWER:</b>	<b>LAKE:</b>

PROPERTY LINE	
BLOCK LIMIT	GREAT LOT LINE
SECTION LIMIT	SUBDIVISION LOT LINE
TOWN VILLAGE CITY	STATE ROUTE
COUNTY LINE	COUNTY ROUTE
RAILROAD	STREET OR TOWN ROAD

LEGEND	
SCHOOL DISTRICT LINE	STREET OR TOWN ROAD
FIRE DISTRICT LINE	MAIN ST
WATER DISTRICT LINE	
AGRICULTURAL DISTRICT	
LIGHT DISTRICT	
NAD 83 TIC LINES	

CALCULATED ACREAGE	
DEED ACREAGE	9.8 A (C)
SCALED DIMENSION	9.8 A
DEED DIMENSION	150.2
COORDINATE LOCATOR	
DENOTES COMMON OWNER	

SHEET INDEX	
V037.77	050.00
V049.35	V049.36 050.01

**TAX MAP**  
**VILLAGE OF SOUTH GLENS FALLS**  
**SARATOGA COUNTY, NEW YORK**  
 TAXABLE STATUS DATE: March 1, 2026  
 MAP EXPORTED ON: March 20, 2026