



FD026  
414401

HUDSON  
RIVER

**REAL PROPERTY TAX MAP**  
 PREPARED FOR: SARATOGA COUNTY BOARD OF SUPERVISORS  
 UNDER SUPERVISION OF: REAL PROPERTY TAX SERVICE AGENCY  
 PREPARED BY:  
 L. ROBERT KIMBALL CONSULTING ENGINEERS, EBENSBURG, PA (1973-1978)  
 CONVERTED TO DIGITAL FORMAT BY THE L.A. GROUP SARATOGA SPRINGS, NY (1986-1998)  
 CONVERTED TO DIGITAL FORMAT FROM NAD 27 TO NAD 83 BY WILSON MAPPING, INC. (2002)  
 CONVERTED TO ESRI GEDATABASE FORMAT BY FOUNTAINS SPATIAL, INC. (2007-2008)

THIS MAP HAS BEEN PREPARED FROM MAPS AND DEEDS AND OTHER INFORMATION OF PUBLIC RECORD. IN ACCORDANCE WITH THE PROVISIONS OF THE REAL PROPERTY TAX LAW, FOR ASSESSMENT PURPOSES ONLY.  
 IT DOES NOT REPRESENT A LAND SURVEY AND MUST NOT BE CONSTRUED AS SUCH.  
 DESCRIPTIONS OF REAL PROPERTY TAKEN HEREFROM FOR THE PURPOSE OF CONVEYANCE OR TRANSFER MUST BE LIMITED TO THOSE NECESSARY AND INCIDENTAL TO THE ADMINISTRATION OF THE REAL PROPERTY TAX LAW.

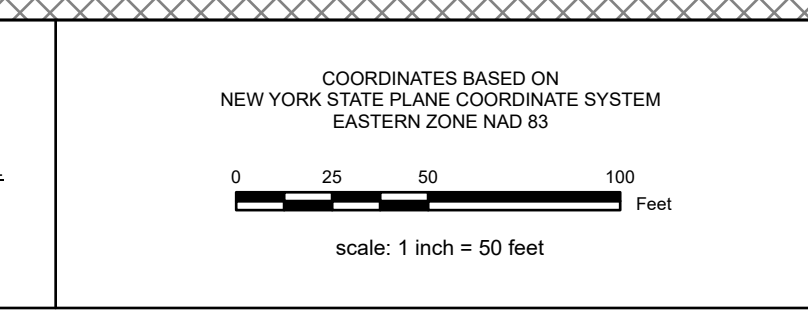

**SPECIAL DISTRICTS**

|  |               |
|--|---------------|
| <b>SCHOOL:</b> SOUTH GLENS FALLS CENTRAL 41401 | <b>LIGHT:</b> |
| <b>FIRE:</b>                                   | <b>WATER:</b> |
| <b>AG:</b>                                     | <b>PARK:</b>  |
| <b>SEWER:</b>                                  | <b>LAKE:</b>  |

**LEGEND**

|                   |                      |                       |                       |
|-------------------|----------------------|-----------------------|-----------------------|
| PROPERTY LINE     | GREAT LOT LINE       | SCHOOL DISTRICT LINE  | GREAT LOT NUMBER      |
| BLOCK LIMIT       | SUBDIVISION LOT LINE | FIRE DISTRICT LINE    | TAX MAP BLOCK NUMBER  |
| SECTION LIMIT     | STATE ROUTE          | WATER DISTRICT LINE   | FILED PLAN LOT NUMBER |
| TOWN VILLAGE CITY | COUNTY ROUTE         | AGRICULTURAL DISTRICT | TAX MAP PARCEL NUMBER |
| COUNTY LINE       | STREET OR TOWN ROAD  | LIGHT DISTRICT        | STREAM/WATERBODY      |
| RAILROAD          | MAIN ST              | NAD 83 TIC LINES      |                       |

|  |  |
|--|--|
| CALCULATED ACREAGE<br>DEED ACREAGE<br>SCALED DIMENSION<br>DEED DIMENSION<br>COORDINATE LOCATOR<br>DENOTES COMMON OWNER | 9.8 A (C)<br>8.8 A<br>150 (S)<br>150.2 |
|--|--|

**SHEET INDEX**

|        |        |
|--------|--------|
| 037.00 | 037.00 |
| 037.70 | 037.70 |
| 049.00 | 050.00 |
| 050.00 | 050.00 |

**TAX MAP V037.77**  
**VILLAGE OF SOUTH GLENS FALLS**  
 SARATOGA COUNTY, NEW YORK  
 TAXABLE STATUS DATE: March 1, 2026  
 MAP EXPORTED ON: March 20, 2026