

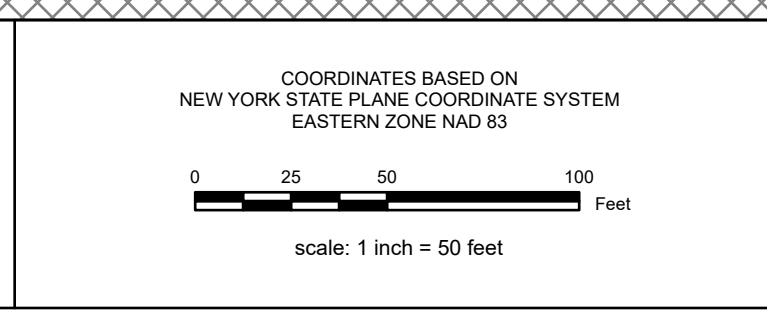

REAL PROPERTY TAX MAP
 PREPARED FOR: SARATOGA COUNTY BOARD OF SUPERVISORS
 UNDER SUPERVISION OF: REAL PROPERTY TAX SERVICE AGENCY
 PREPARED BY: L. ROBERT KIMBALL CONSULTING ENGINEERS, EBERSBURG, PA (1973-1978)
 CONVERTED TO DIGITAL FORMAT BY THE L.A. GROUP SARATOGA SPRINGS, NY (1986-1998)
 CONVERTED TO DIGITAL FORMAT FROM NAD 27 TO NAD 83 BY WILLEMAPPING, INC. (2002)
 CONVERTED TO ESRI GDB/DATABASE FORMAT BY FOUNTAINS SPATIAL, INC. (2007-2008)

THIS MAP HAS BEEN PREPARED FROM MAPS AND DEEDS AND OTHER INFORMATION OF PUBLIC RECORD. IN ACCORDANCE WITH THE PROVISIONS OF THE REAL PROPERTY TAX LAW, FOR ASSESSMENT PURPOSES ONLY.
 IT DOES NOT REPRESENT A LAND SURVEY AND MUST NOT BE CONSTRUED AS SUCH.
 DESCRIPTIONS OF REAL PROPERTY TAKEN HEREFROM FOR THE PURPOSE OF CONVEYANCE OR TRANSFER, MUST BE LIMITED TO THOSE NECESSARY AND INCIDENTAL TO THE ADMINISTRATION OF THE REAL PROPERTY TAX LAW.



SPECIAL DISTRICTS

SCHOOL: SOUTH GLENS FALLS CENTRAL 414401	LIGHT:	PROPERTY LINE:
FIRE:	WATER:	BLOCK LIMIT:
AG:	PARK:	SECTION LIMIT:
SEWER:	LAKE:	TOWN/VILLAGE/CITY:
		COUNTY LINE:
		RAILROAD:

LEGEND

GREAT LOT LINE:	SCHOOL DISTRICT LINE:	GREAT LOT NUMBER:
SUBDIVISION LOT LINE:	FIRE DISTRICT LINE:	TAX MAP BLOCK NUMBER:
STATE ROUTE:	WATER DISTRICT LINE:	FILED PLAN LOT NUMBER:
COUNTY ROUTE:	AGRICULTURAL DISTRICT:	TAX MAP PARCEL NUMBER:
STREET OR TOWN ROAD:	LIGHT DISTRICT:	STREAM/WATERBODY:
	NAD 83 TIC LINES:	

COORDINATE LOCATOR:	9.8 A (C):
DENOTES COMMON OWNER:	9.8 A:
	150 (S):
	150.2:

SHEET INDEX

037.00	037.00	037.00
037.00	037.00	037.00

TAX MAP **V037.71**
VILLAGE OF SOUTH GLENS FALLS
SARATOGA COUNTY, NEW YORK
 TAXABLE STATUS DATE: March 1, 2026 MAP EXPORTED ON: March 20, 2026