

REAL PROPERTY TAX MAP
 PREPARED FOR: SARATOGA COUNTY BOARD OF SUPERVISORS
 UNDER SUPERVISION OF: REAL PROPERTY TAX SERVICE AGENCY
 PREPARED BY: L. ROBERT KIMBALL CONSULTING ENGINEERS, ERIENSBURG, PA (1973-1978)
 CONVERTED TO DIGITAL FORMAT BY THE L.A. GROUP SARATOGA SPRINGS, NY (1996-1998)
 CONVERTED TO DIGITAL FORMAT FROM NAD 27 TO NAD 83 BY WILSON MAPPING, INC. (2002)
 CONVERTED TO ESRI GDB/DATABASE FORMAT BY FOUNTAINS SPATIAL, INC. (2007-2008)

THIS MAP HAS BEEN PREPARED FROM MAPS AND DEEDS AND OTHER INFORMATION OF PUBLIC RECORD. IN ACCORDANCE WITH THE PROVISIONS OF THE REAL PROPERTY TAX LAW, FOR ASSESSMENT PURPOSES ONLY.
 IT DOES NOT REPRESENT A LAND SURVEY AND MUST NOT BE CONSTRUED AS SUCH.
 DESCRIPTIONS OF REAL PROPERTY TAKEN HEREFROM FOR THE PURPOSE OF CONVEYANCE OR TRANSFER, MUST BE LIMITED TO THOSE NECESSARY AND INCIDENTAL TO THE ADMINISTRATION OF THE REAL PROPERTY TAX LAW.

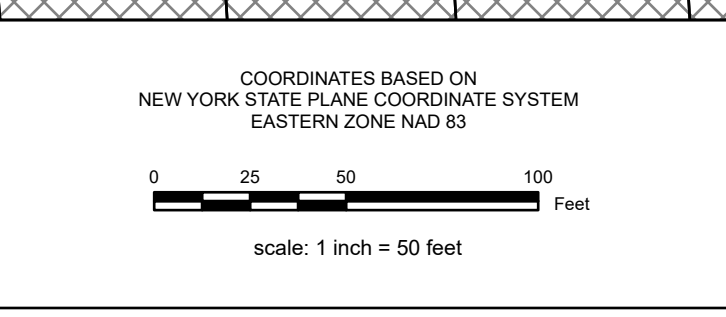

SPECIAL DISTRICTS

SCHOOL: SOUTH GLENS FALLS CENTRAL 41401	LIGHT:
FIRE:	WATER:
AG:	PARK:
SEWER:	LAKE:

PROPERTY LINE
 BLOCK LIMIT
 SECTION LIMIT
 TOWN/VILLAGE/CITY
 COUNTY LINE
 RAILROAD

LEGEND

GREAT LOT LINE	SCHOOL DISTRICT LINE	GREAT LOT NUMBER
SUBDIVISION LOT LINE	FIRE DISTRICT LINE	TAX MAP BLOCK NUMBER
STATE ROUTE	WATER DISTRICT LINE	FILED PLAN LOT NUMBER
COUNTY ROUTE	AGRICULTURAL DISTRICT	TAX MAP PARCEL NUMBER
STREET OR TOWN ROAD	LIGHT DISTRICT	STREAM/WATERBODY
	NAD 83 TIC LINES	

CALCULATED ACREAGE
 DEED ACREAGE
 SCALED DIMENSION
 DEED DIMENSION
 COORDINATE LOCATOR
 DENOTES COMMON OWNER

8.8 A (C)
 8.8 A
 150 (S)
 150.2

037.00 037.00 037.00
 037.00 037.00
 V037.77 V037.78 V037.79

SHEET INDEX

TAX MAP V037.70
VILLAGE OF SOUTH GLENS FALLS
 SARATOGA COUNTY, NEW YORK
 TAXABLE STATUS DATE: March 1, 2026
 MAP EXPORTED ON: March 20, 2026