

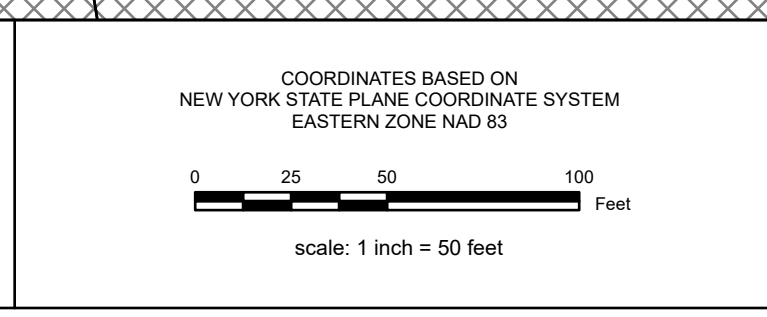

**REAL PROPERTY TAX MAP**  
 PREPARED FOR: SARATOGA COUNTY BOARD OF SUPERVISORS  
 UNDER SUPERVISION OF: REAL PROPERTY TAX SERVICE AGENCY  
 PREPARED BY:  
 L. ROBERT KIMBALL CONSULTING ENGINEERS, EBENSBURG, PA (1973-1978)  
 CONVERTED TO DIGITAL FORMAT BY THE L.A. GROUP SARATOGA SPRINGS, NY (1998-1999)  
 CONVERTED TO DIGITAL FORMAT FROM NAD 27 TO NAD 83 BY WILSON MAPPING, INC. (2002)  
 CONVERTED TO ESRI GECODATABASE FORMAT BY FOUNTAINS SPATIAL, INC. (2007-2008)

THIS MAP HAS BEEN PREPARED FROM MAPS AND DEEDS AND OTHER INFORMATION OF PUBLIC RECORD. IN ACCORDANCE WITH THE PROVISIONS OF THE REAL PROPERTY TAX LAW, FOR ASSESSMENT PURPOSES ONLY.  
 IT DOES NOT REPRESENT A LAND SURVEY AND MUST NOT BE CONSTRUED AS SUCH.  
 DESCRIPTIONS OF REAL PROPERTY TAKEN HEREFROM FOR THE PURPOSE OF CONVEYANCE OR TRANSFER, MUST BE LIMITED TO THOSE NECESSARY AND INCIDENTAL TO THE ADMINISTRATION OF THE REAL PROPERTY TAX LAW.



**SPECIAL DISTRICTS**

<b>SCHOOL:</b> SOUTH GLENS FALLS CENTRAL 41402	<b>LIGHT:</b>
<b>FIRE:</b>	<b>WATER:</b>
<b>AG:</b>	<b>PARK:</b>
<b>SEWER:</b>	<b>LAKE:</b>

**PROPERTY LINE**  
 BLOCK LIMIT  
 SECTION LIMIT  
 TOWN/VILLAGE/CITY  
 COUNTY LINE  
 RAILROAD

**LEGEND**

GREAT LOT LINE	SCHOOL DISTRICT LINE
SUBDIVISION LOT LINE	FIRE DISTRICT LINE
STATE ROUTE	WATER DISTRICT LINE
COUNTY ROUTE	AGRICULTURAL DISTRICT
STREET OR TOWN ROAD	LIGHT DISTRICT
MAIN ST	NAD 83 TIC LINES

GREAT LOT NUMBER	CALCULATED ACREAGE	9.9 A (C)
TAX MAP BLOCK NUMBER	DEED ACREAGE	9.9 A
FILED PLAN LOT NUMBER	SCALED DIMENSION	150 (S)
TAX MAP PARCEL NUMBER	DEED DIMENSION	150.2
160.00-3.9	COORDINATE LOCATOR	
	IDENTIFIES COMMON OWNER	

**SHEET INDEX**

V037.53	V037.54
037.00	037.00
037.00	037.00

**TAX MAP V037.61**  
**VILLAGE OF SOUTH GLENS FALLS**  
 SARATOGA COUNTY, NEW YORK  
 TAXABLE STATUS DATE: March 1, 2026  
 MAP EXPORTED ON: March 20, 2026