

REAL PROPERTY TAX MAP
 PREPARED FOR: SARATOGA COUNTY BOARD OF SUPERVISORS
 UNDER SUPERVISION OF: REAL PROPERTY TAX SERVICE AGENCY
 PREPARED BY:
 L. ROBERT KIMBALL, CONSULTING ENGINEERS, EBENSBURG, PA (1973-1978)
 CONVERTED TO DIGITAL FORMAT BY THE L.A. GROUP SARATOGA SPRINGS, NY (1986-1998)
 CONVERTED TO DIGITAL FORMAT FROM NAD 27 TO NAD 83 BY WELLES-MAPPING, INC. (2002)
 CONVERTED TO ESRI GECODATABASE FORMAT BY FOUNTAINS SPATIAL, INC. (2007-2008)

THIS MAP HAS BEEN PREPARED FROM MAPS AND DEEDS AND OTHER INFORMATION OF PUBLIC RECORD. IN ACCORDANCE WITH THE PROVISIONS OF THE REAL PROPERTY TAX LAW, FOR ASSESSMENT PURPOSES ONLY.
 IT DOES NOT REPRESENT A LAND SURVEY AND MUST NOT BE CONSTRUED AS SUCH.
 DESCRIPTIONS OF REAL PROPERTY TAKEN HEREFROM FOR THE PURPOSE OF CONVEYANCE OR TRANSFER MUST BE LIMITED TO THOSE NECESSARY AND INCIDENTAL TO THE ADMINISTRATION OF THE REAL PROPERTY TAX LAW.

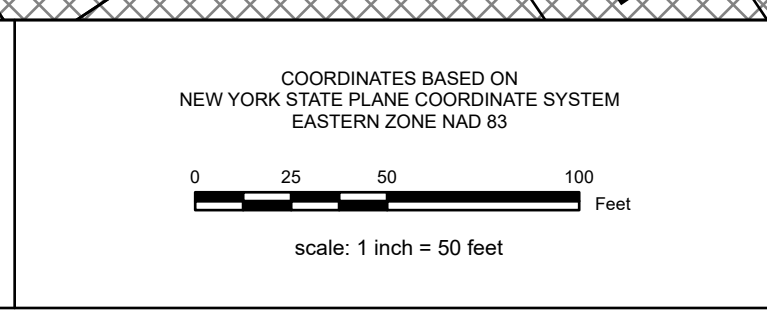

SPECIAL DISTRICTS	
SCHOOL: SOUTH GLENS FALLS CENTRAL 414401	LIGHT:
FIRE:	WATER:
AG:	PARK:
SEWER:	LAKE:

PROPERTY LINE	GREAT LOT LINE
BLOCK LIMIT	SUBDIVISION LOT LINE
SECTION LIMIT	STATE ROUTE
TOWN/VILLAGE/CITY	COUNTY ROUTE
COUNTY LINE	STREET OR TOWN ROAD
RAILROAD	MAIN ST

LEGEND	
SCHOOL DISTRICT LINE	GREAT LOT NUMBER
FIRE DISTRICT LINE	TAX MAP BLOCK NUMBER
WATER DISTRICT LINE	FILED PLAN LOT NUMBER
AGRICULTURAL DISTRICT	TAX MAP PARCEL NUMBER
LIGHT DISTRICT	STREAM/WATERBODY
NAD 83 TIC LINES	

CALCULATED ACREAGE	
DEED ACREAGE	9.8 A (C)
SCALED DIMENSION	8.8 A
DEED DIMENSION	150.2 (S)
COORDINATE LOCATOR	
DENOTES COMMON OWNER	

SHEET INDEX		
037.00	037.00	037.00
037.00	037.00	037.00
037.00	037.00	037.00

TAX MAP **V037.38**
VILLAGE OF SOUTH GLENS FALLS
SARATOGA COUNTY, NEW YORK
 TAXABLE STATUS DATE: March 1, 2026 MAP EXPORTED ON: March 20, 2026