

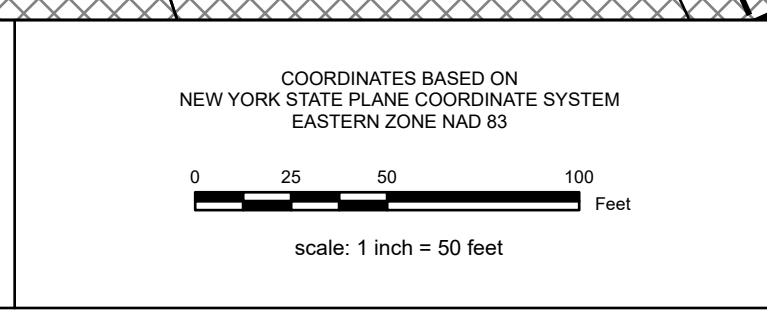

REAL PROPERTY TAX MAP
 PREPARED FOR: SARATOGA COUNTY BOARD OF SUPERVISORS
 UNDER SUPERVISION OF: REAL PROPERTY TAX SERVICE AGENCY
 PREPARED BY:
 L. ROBERT KIMBALL CONSULTING ENGINEERS, ERIENSBURG, PA (1973-1978)
 CONVERTED TO DIGITAL FORMAT BY THE L.A. GROUP SARATOGA SPRINGS, NY (1986-1998)
 CONVERTED TO DIGITAL FORMAT FROM NAD 27 TO NAD 83 BY WILSON MAPPING, INC. (2002)
 CONVERTED TO ESRI GDB/DATABASE FORMAT BY FOUNTAINS SPITAL, INC. (2007-2008)

THIS MAP HAS BEEN PREPARED FROM MAPS AND DEEDS AND OTHER INFORMATION OF PUBLIC RECORD. IN ACCORDANCE WITH THE PROVISIONS OF THE REAL PROPERTY TAX LAW, FOR ASSESSMENT PURPOSES ONLY.
 IT DOES NOT REPRESENT A LAND SURVEY AND MUST NOT BE CONSTRUED AS SUCH.
 DESCRIPTIONS OF REAL PROPERTY TAKEN HEREFROM FOR THE PURPOSE OF CONVEYANCE OR TRANSFER MUST BE LIMITED TO THOSE NECESSARY AND INCIDENTAL TO THE ADMINISTRATION OF THE REAL PROPERTY TAX LAW.



| SPECIAL DISTRICTS | |
|--|---|
| SCHOOL: SOUTH GLENS FALLS CENTRAL 414401 | LIGHT: SINGLEWOOD LIGHTING 13015 |
| FIRE: MOREAU FIRE PROTECTION 10005 | WATER: MOREAU CONSOLIDATED WATER #1 WY008 |
| AG: | PARK: |
| SEWER: | LAKE: |

| PROPERTY LINE | |
|-------------------|----------------------|
| BLOCK LIMIT | GREAT LOT LINE |
| SECTION LIMIT | SUBDIVISION LOT LINE |
| TOWN/VILLAGE/CITY | STATE ROUTE |
| COUNTY LINE | COUNTY ROUTE |
| RAILROAD | STREET OR TOWN ROAD |

| LEGEND | |
|-----------------------|---------------------|
| SCHOOL DISTRICT LINE | STREET WATERBODY |
| FIRE DISTRICT LINE | STATE ROUTE |
| WATER DISTRICT LINE | COUNTY ROUTE |
| AGRICULTURAL DISTRICT | STREET OR TOWN ROAD |
| LIGHT DISTRICT | MAIN ST |
| NAD 83 TIC LINES | |

| CALCULATED ACREAGE | |
|----------------------|-----------|
| DEED ACREAGE | 9.8 A (C) |
| SCALED DIMENSION | 8.8 A |
| DEED DIMENSION | 150.2 (S) |
| COORDINATE LOCATOR | 150.2 (S) |
| DENOTES COMMON OWNER | |

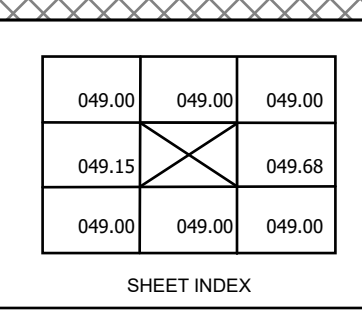

TAX MAP 049.67
TOWN OF MOREAU
 SARATOGA COUNTY, NEW YORK
 TAXABLE STATUS DATE: March 1, 2026
 MAP EXPORTED ON: March 20, 2026