

REAL PROPERTY TAX MAP
 SARATOGA COUNTY BOARD OF SUPERVISORS
 UNDER SUPERVISION OF: REAL PROPERTY TAX SERVICE AGENCY
 PREPARED BY:
 L. ROBERT KIMBALL CONSULTING ENGINEERS, ERIENSBURG, PA (1973-1978)
 CONVERTED TO DIGITAL FORMAT BY THE L.A. GROUP SARATOGA SPRINGS, NY (1986-1998)
 CONVERTED TO DIGITAL FORMAT FROM NAD 27 TO NAD 83 BY WILSON MAPPING, INC. (2002)
 CONVERTED TO ESRI GDB/DATABASE FORMAT BY FOUNTAINS SPATIAL, INC. (2007-2008)

THIS MAP HAS BEEN PREPARED FROM MAPS AND DEEDS AND OTHER INFORMATION OF PUBLIC RECORD IN ACCORDANCE WITH THE PROVISIONS OF THE REAL PROPERTY TAX LAW, FOR ASSESSMENT PURPOSES ONLY.
 IT DOES NOT REPRESENT A LAND SURVEY AND MUST NOT BE CONSTRUED AS SUCH.
 DESCRIPTIONS OF REAL PROPERTY TAKEN HEREFROM FOR THE PURPOSE OF CONVEYANCE OR TRANSFER, MUST BE LIMITED TO THOSE NECESSARY AND INCIDENTAL TO THE ADMINISTRATION OF THE REAL PROPERTY TAX LAW.

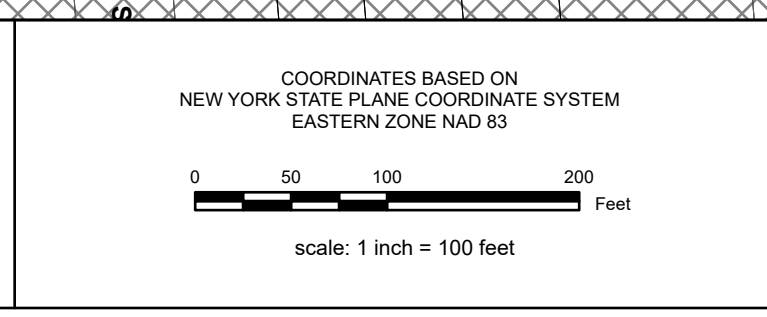

SPECIAL DISTRICTS

| | |
|---------------------------------------|---|
| SCHOOL: BALLSTON CENTRAL 14020 | WATER: LOWER GREENFIELD AVE WATER W104 |
| FIRE: FIRE PROTECTION 1 1004 | LIGHT: |
| AG: | PARK: |
| SEWER: | LAKE: |

PROPERTY LINE

| | |
|-------------------|----------------------|
| BLOCK LIMIT | GREAT LOT LINE |
| SECTION LIMIT | SUBDIVISION LOT LINE |
| TOWN/VILLAGE/CITY | STATE ROUTE |
| COUNTY LINE | COUNTY ROUTE |
| RAILROAD | STREET OR TOWN ROAD |

LEGEND

| | |
|-----------------------|-------|
| SCHOOL DISTRICT LINE | WATER |
| FIRE DISTRICT LINE | WATER |
| WATER DISTRICT LINE | WATER |
| AGRICULTURAL DISTRICT | WATER |
| LIGHT DISTRICT | WATER |
| NAD 83 TIC LINES | WATER |

| | | | | | |
|-----------------------|-----------------------|-----------------|--------------------|-------------------------|-------------------------|
| GREAT LOT NUMBER | TAX MAP BLOCK NUMBER | SCALED ACREAGE | SCALE DIMENSION | COORDINATE LOCATOR | IDENTIFIES COMMON OWNER |
| TAX MAP PARCEL NUMBER | TAX MAP PARCEL NUMBER | SCALE DIMENSION | COORDINATE LOCATOR | IDENTIFIES COMMON OWNER | |

TAX MAP 203.14

TOWN OF MILTON
 SARATOGA COUNTY, NEW YORK

TAXABLE STATUS DATE: March 1, 2026
 MAP EXPORTED ON: March 12, 2026