

REAL PROPERTY TAX MAP
 PREPARED FOR: SARATOGA COUNTY BOARD OF SUPERVISORS
 UNDER SUPERVISION OF: REAL PROPERTY TAX SERVICE AGENCY
 PREPARED BY:
 L. ROBERT KIMBALL CONSULTING ENGINEERS, ERIENSBURG, PA (1973-1978)
 CONVERTED TO DIGITAL FORMAT BY THE L.A. GROUP SARATOGA SPRINGS, NY (1986-1998)
 CONVERTED TO DIGITAL FORMAT FROM NAD 27 TO NAD 83 BY WILSON MAPPING, INC. (2002)
 CONVERTED TO ESRI GEDATABASE FORMAT BY FOUNTAINS SPATIAL, INC. (2007-2008)

THIS MAP HAS BEEN PREPARED FROM MAPS AND DEEDS AND OTHER INFORMATION OF PUBLIC RECORD IN ACCORDANCE WITH THE PROVISIONS OF THE REAL PROPERTY TAX LAW, FOR ASSESSMENT PURPOSES ONLY.
 IT DOES NOT REPRESENT A LAND SURVEY AND MUST NOT BE CONSTRUED AS SUCH.
 DESCRIPTIONS OF REAL PROPERTY TAKEN HEREFROM FOR THE PURPOSE OF CONVEYANCE OR TRANSFER, MUST BE LIMITED TO THOSE NECESSARY AND INCIDENTAL TO THE ADMINISTRATION OF THE REAL PROPERTY TAX LAW.

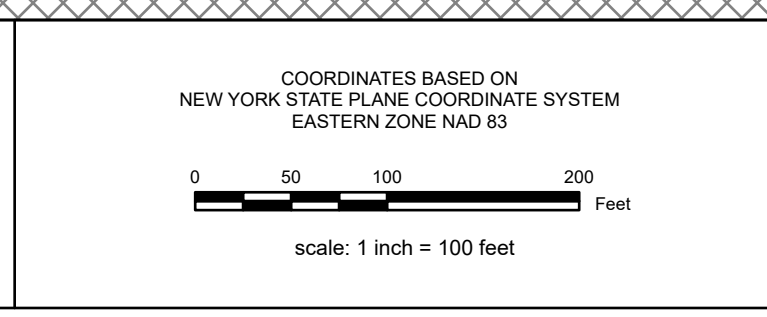

SPECIAL DISTRICTS

SCHOOL: SARATOGA SPRINGS CENTRAL 41100	WATER:
FIRE: HUDON FIRE 1005	LIGHT:
AG:	PARK:
SEWER:	LAKE:

PROPERTY LINE

BLOCK LIMIT	GREAT LOT LINE
SECTION LIMIT	SUBDIVISION LOT LINE
TOWN/VILLAGE/CITY	STATE ROUTE
COUNTY LINE	COUNTY ROUTE
RAILROAD	STREET OR TOWN ROAD

LEGEND

SCHOOL DISTRICT LINE	GREAT LOT NUMBER	CALCULATED ACREAGE	9.8 A (C)
FIRE DISTRICT LINE	TAX MAP BLOCK NUMBER	DEED ACREAGE	8.5 A
WATER DISTRICT LINE	FILED PLAN LOT NUMBER	SCALED DIMENSION	150 (S)
AGRICULTURAL DISTRICT	TAX MAP PARCEL NUMBER	DEED DIMENSION	150.2
LIGHT DISTRICT	STREAM/WATERBODY	COORDINATE LOCATOR	
NAD 83 TIC LINES		DENOTES COMMON OWNER	

TAX MAP

177.09	177.00	177.00
177.13	177.00	177.00
177.00	177.00	177.00

SHEET INDEX

TOWN OF MILTON
 SARATOGA COUNTY, NEW YORK
 TAX MAP 177.14
 TAXABLE STATUS DATE: March 1, 2026
 MAP EXPORTED ON: March 12, 2026