

REAL PROPERTY TAX MAP
 PREPARED FOR: SARATOGA COUNTY BOARD OF SUPERVISORS
 UNDER SUPERVISION OF: REAL PROPERTY TAX SERVICE AGENCY
 PREPARED BY:
 L. ROBERT KIMBALL CONSULTING ENGINEERS, EBERSBURG, PA (1973-1978)
 CONVERTED TO DIGITAL FORMAT BY THE L.A. GROUP SARATOGA SPRINGS, NY (1986-1998)
 CONVERTED TO DIGITAL FORMAT FROM NAD 27 TO NAD 83 BY WELLS & WARRING, INC. (2002)
 CONVERTED TO ESRI GDB/DATABASE FORMAT BY FOUNTAINS SPATIAL, INC. (2007-2008)

THIS MAP HAS BEEN PREPARED FROM MAPS AND DEEDS AND OTHER INFORMATION OF PUBLIC RECORD. IN ACCORDANCE WITH THE PROVISIONS OF THE REAL PROPERTY TAX LAW, FOR ASSESSMENT PURPOSES ONLY.
 IT DOES NOT REPRESENT A LAND SURVEY AND MUST NOT BE CONSTRUED AS SUCH.
 DESCRIPTIONS OF REAL PROPERTY TAKEN HEREFROM FOR THE PURPOSE OF CONVEYANCE OR TRANSFER, MUST BE LIMITED TO THOSE NECESSARY AND INCIDENTAL TO THE ADMINISTRATION OF THE REAL PROPERTY TAX LAW.

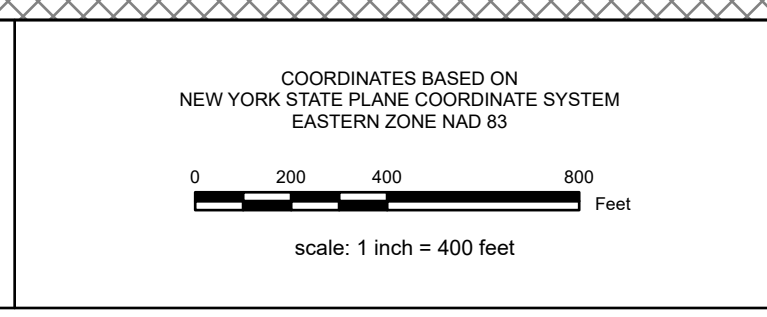

SPECIAL DISTRICTS

SCHOOL:	SARATOGA SPRINGS CENTRAL 41300 BALLSTON CENTRAL 41401
FIRE:	HULON FIRE FOODS
AG:	
SEWER:	

PROPERTY LINE

BLOCK LIMIT	---
SECTION LIMIT	---
TOWN/VILLAGE/CITY	---
COUNTY LINE	---
RAILROAD	---

WATER: ---
LIGHT: ---
PARK: ---
LAKE: ---

LEGEND

GREAT LOT LINE	---
SUBDIVISION LOT LINE	---
STATE ROUTE	---
COUNTY ROUTE	---
STREET OR TOWN ROAD	---
SCHOOL DISTRICT LINE	---
FIRE DISTRICT LINE	---
WATER DISTRICT LINE	---
AGRICULTURAL DISTRICT	---
LIGHT DISTRICT	---
NAD 83 TIC LINES	---
TAX MAP BLOCK NUMBER	①
FILED PLAN LOT NUMBER	⑨
TAX MAP PARCEL NUMBER	160.00-3.9
STREAM/WATERBODY	---
GREAT LOT NUMBER	163.00
TAX MAP BLOCK NUMBER	176.00
FILED PLAN LOT NUMBER	189.00
TAX MAP PARCEL NUMBER	190.00
CALCULATED ACREAGE	9.8 A (C)
DEED ACREAGE	9.8 A
SCALED DIMENSION	150.2
DEED DIMENSION	150.2
COORDINATE LOCATOR	+
DENOTES COMMON OWNER	+

TAX MAP

163.00	164.00
176.00	177.00
189.00	190.00

SHEET INDEX

TOWN OF MILTON
 SARATOGA COUNTY, NEW YORK
 TAXABLE STATUS DATE: March 1, 2026
 MAP EXPORTED ON: March 12, 2026