

**REAL PROPERTY TAX MAP**  
 PREPARED FOR: SARATOGA COUNTY BOARD OF SUPERVISORS  
 UNDER SUPERVISION OF: REAL PROPERTY TAX SERVICE AGENCY  
 PREPARED BY:  
 L. ROBERT KIMBALL CONSULTING ENGINEERS, ERIENSBURG, PA (1973-1978)  
 CONVERTED TO DIGITAL FORMAT BY THE L.A. GROUP SARATOGA SPRINGS, NY (1998-1999)  
 CONVERTED TO DIGITAL FORMAT FROM NAD 27 TO NAD 83 BY WILSON MAPPING, INC. (2002)  
 CONVERTED TO ESRI GDB/DATABASE FORMAT BY FOUNTAINS SPITAL, INC. (2007-2008)

THIS MAP HAS BEEN PREPARED FROM MAPS AND DEEDS AND OTHER INFORMATION OF PUBLIC RECORD, IN ACCORDANCE WITH THE PROVISIONS OF THE REAL PROPERTY TAX LAW, FOR ASSESSMENT PURPOSES ONLY.  
 IT DOES NOT REPRESENT A LAND SURVEY AND MUST NOT BE CONSTRUED AS SUCH.  
 DESCRIPTIONS OF REAL PROPERTY TAKEN HEREFROM FOR THE PURPOSE OF CONVEYANCE OR TRANSFER, MUST BE LIMITED TO THOSE NECESSARY AND INCIDENTAL TO THE ADMINISTRATION OF THE REAL PROPERTY TAX LAW.

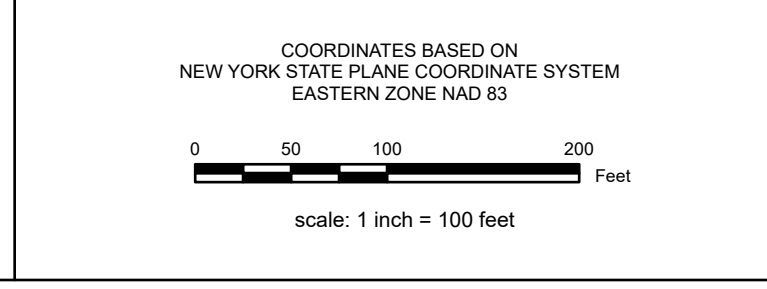

SPECIAL DISTRICTS	
AG: HAZA FIRE PROTECTION 1003	LAKE:
SCHOOL: HALLSTON CENTRAL 41001	WATER:
SEWER:	LIGHT:
	PARK:

PROPERTY LINE	
BLOCK LIMIT	GREAT LOT LINE
SECTION LIMIT	SUBDIVISION LOT LINE
TOWN/VILLAGE/CITY	STATE ROUTE
COUNTY LINE	COUNTY ROUTE
RAILROAD	STREET OR TOWN ROAD

LEGEND	
SCHOOL DISTRICT LINE	--- ---
FIRE DISTRICT LINE	--- ---
WATER DISTRICT LINE	--- ---
AGRICULTURAL DISTRICT	--- ---
LIGHT DISTRICT	--- ---
NAD 83 TIC LINES	+

GREAT LOT NUMBER	①	CALCULATED ACREAGE	9.8 A (C)
TAX MAP BLOCK NUMBER	②	DEED ACREAGE	8.8 A
FILED PLAN LOT NUMBER	③	SCALED DIMENSION	150 (S)
TAX MAP PARCEL NUMBER	④	DEED DIMENSION	150.2
STREAM/WATERBODY	⑤	COORDINATE LOCATOR	+
		DENOTES COMMON OWNER	+

SHEET INDEX		
229.15	230.13	230.00
229.20	230.00	230.00
240.00	241.05	241.00

**TAX MAP 230.17**  
**TOWN OF MALTA**  
**SARATOGA COUNTY, NEW YORK**  
 TAXABLE STATUS DATE: March 1, 2028  
 MAP EXPORTED ON: March 12, 2028