

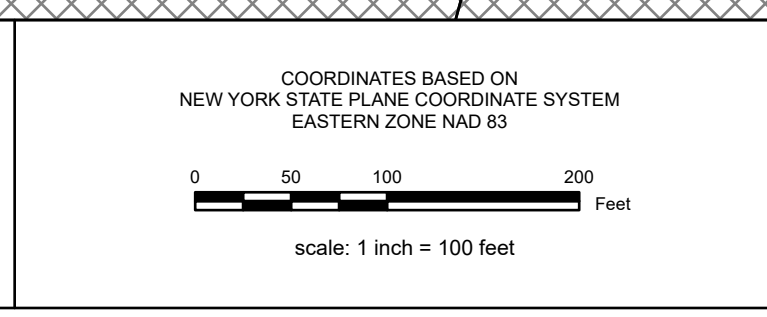

**REAL PROPERTY TAX MAP**  
 PREPARED FOR: SARATOGA COUNTY BOARD OF SUPERVISORS  
 UNDER SUPERVISION OF: REAL PROPERTY TAX SERVICE AGENCY  
 PREPARED BY:  
 L. ROBERT KIMBALL CONSULTING ENGINEERS, EBERSBURG, PA (1973-1978)  
 CONVERTED TO DIGITAL FORMAT BY THE L.A. GROUP SARATOGA SPRINGS, NY (1998-1999)  
 CONVERTED TO DIGITAL FORMAT FROM NAD 27 TO NAD 83 BY WELLS & WAPPING, INC. (2002)  
 CONVERTED TO ESRI GDB/DATABASE FORMAT BY FOUNTAINS SPITAL, INC. (2007-2008)

THIS MAP HAS BEEN PREPARED FROM MAPS AND DEEDS AND OTHER INFORMATION OF PUBLIC RECORD. IN ACCORDANCE WITH THE PROVISIONS OF THE REAL PROPERTY TAX LAW, FOR ASSESSMENT PURPOSES ONLY.  
 IT DOES NOT REPRESENT A LAND SURVEY AND MUST NOT BE CONSTRUED AS SUCH.  
 DESCRIPTIONS OF REAL PROPERTY TAKEN HEREFROM FOR THE PURPOSE OF CONVEYANCE OR TRANSFER MUST BE LIMITED TO THOSE NECESSARY AND INCIDENTAL TO THE ADMINISTRATION OF THE REAL PROPERTY TAX LAW.



SPECIAL DISTRICTS	
AG: [Symbol]	LAKE: SARATOGA LAKE PROT DIST PR001
FIRE: MALTA FIRE PROTECTION FD02	PROPERTY LINE
SCHOOL: HULLSTON CENTRAL 41001	BLOCK LIMIT
SEWER: [Symbol]	SECTION LIMIT
	TOWN/VILLAGE/CITY
	COUNTY LINE
	RAILROAD

LEGEND	
[Symbol] GREAT LOT LINE	[Symbol] SCHOOL DISTRICT LINE
[Symbol] SUBDIVISION LOT LINE	[Symbol] FIRE DISTRICT LINE
[Symbol] STATE ROUTE	[Symbol] WATER DISTRICT LINE
[Symbol] COUNTY ROUTE	[Symbol] AGRICULTURAL DISTRICT
[Symbol] STREET OR TOWN ROAD	[Symbol] LIGHT DISTRICT
[Symbol] MAIN ST	[Symbol] NAD 83 TIC LINES

[Symbol] GREAT LOT NUMBER	[Symbol] CALCULATED ACREAGE	[Symbol] 9.8 A (C)
[Symbol] TAX MAP BLOCK NUMBER	[Symbol] DEED ACREAGE	[Symbol] 8.8 A
[Symbol] FILED PLAN LOT NUMBER	[Symbol] SCALED DIMENSION	[Symbol] 150 (S)
[Symbol] TAX MAP PARCEL NUMBER	[Symbol] DEED DIMENSION	[Symbol] 150.2
[Symbol] STREAM/WATERBODY	[Symbol] COORDINATE LOCATOR	[Symbol] DENOTES COMMON OWNER

SHEET INDEX		
218.14	218.00	218.00
218.18	230.00	230.00

**TAX MAP** 218.19  
**TOWN OF MALTA**  
 SARATOGA COUNTY, NEW YORK  
 TAXABLE STATUS DATE: March 1, 2028  
 MAP EXPORTED ON: March 12, 2028