

REAL PROPERTY TAX MAP
 PREPARED FOR: SARATOGA COUNTY BOARD OF SUPERVISORS
 UNDER SUPERVISION OF: REAL PROPERTY TAX SERVICE AGENCY
 PREPARED BY: L. ROBERT KIMBALL CONSULTING ENGINEERS, EBERSBURG, PA (1973-1978)
 CONVERTED TO DIGITAL FORMAT BY THE L.A. GROUP SARATOGA SPRINGS, NY (1986-1998)
 CONVERTED TO DIGITAL FORMAT FROM NAD 27 TO NAD 83 BY WILSON MAPING, INC. (2002)
 CONVERTED TO ESRI GEODATABASE FORMAT BY FOUNTAINS SPATIAL, INC. (2007-2008)

THIS MAP HAS BEEN PREPARED FROM MAPS AND DEEDS AND OTHER INFORMATION OF PUBLIC RECORD, IN ACCORDANCE WITH THE PROVISIONS OF THE REAL PROPERTY TAX LAW, FOR ASSESSMENT PURPOSES ONLY.
 IT DOES NOT REPRESENT A LAND SURVEY, AND MUST NOT BE CONSTRUED AS SUCH.
 DESCRIPTIONS OF REAL PROPERTY TAKEN HEREFROM FOR THE PURPOSE OF CONVEYANCE OR TRANSFER, MUST BE LIMITED TO THOSE NECESSARY AND INCIDENTAL TO THE ADMINISTRATION OF THE REAL PROPERTY TAX LAW.

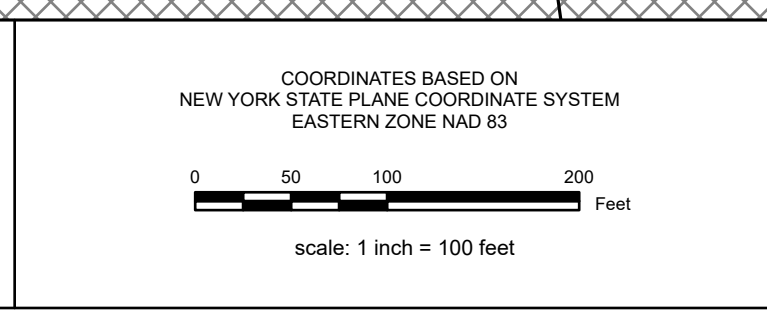

SPECIAL DISTRICTS

SCHOOL: SHENENDEAWA CENTRAL 41242	FIRE: HALBOON WATERFORD FIRE 10065	PROPERTY LINE: [Symbol]
WATER: CONSOLIDATED WT DIST ZONE 3 WT040	LIGHT: [Symbol]	BLOCK LIMIT: [Symbol]
AG: [Symbol]	PARK: [Symbol]	SECTION LIMIT: [Symbol]
LAKE: [Symbol]	SEWER: [Symbol]	TOWN VILLAGE CITY: [Symbol]
		COUNTY LINE: [Symbol]
		RAILROAD: [Symbol]

LEGEND

GREAT LOT LINE: [Symbol]	SCHOOL DISTRICT LINE: [Symbol]	GREAT LOT NUMBER: [Symbol]
SUBDIVISION LOT LINE: [Symbol]	FIRE DISTRICT LINE: [Symbol]	TAX MAP BLOCK NUMBER: [Symbol]
STATE ROUTE: [Symbol]	WATER DISTRICT LINE: [Symbol]	FILED PLAN LOT NUMBER: [Symbol]
COUNTY ROUTE: [Symbol]	AGRICULTURAL DISTRICT: [Symbol]	TAX MAP PARCEL NUMBER: [Symbol]
STREET OR TOWN ROAD: [Symbol]	LIGHT DISTRICT: [Symbol]	STREAM/WATERBODY: [Symbol]
	NAD 83 TIC LINES: [Symbol]	

CALCULATED ACREAGE: 8.8 A (C)	8.8 A (C)
DEED ACREAGE: 8.8 A	8.8 A
SCALED DIMENSION: 150.2	150.2
DEED DIMENSION: 150.2	150.2
COORDINATE LOCATOR: [Symbol]	[Symbol]
DENOTES COMMON OWNER: [Symbol]	[Symbol]

SHEET INDEX

279.00	279.01	279.02
279.03	279.15	279.17
279.17	279.03	279.00

TAX MAP 279.14
TOWN OF HALFMOON
SARATOGA COUNTY, NEW YORK
 TAXABLE STATUS DATE: March 1, 2028
 MAP EXPORTED ON: March 26, 2028