

REAL PROPERTY TAX MAP
 PREPARED FOR: SARATOGA COUNTY BOARD OF SUPERVISORS
 UNDER SUPERVISION OF: REAL PROPERTY TAX SERVICE AGENCY
 PREPARED BY:
 L. ROBERT KIMBALL CONSULTING ENGINEERS, EBENSBURG, PA (1973-1978)
 CONVERTED TO DIGITAL FORMAT BY THE L.A. GROUP SARATOGA SPRINGS, NY (1986-1998)
 CONVERTED TO DIGITAL FORMAT FROM NAD 27 TO NAD 83 BY WILLES MAPPING, INC. (2002)
 CONVERTED TO ESRI GECODATABASE FORMAT BY FOUNTAINS SPITAL, INC. (2007-2008)

THIS MAP HAS BEEN PREPARED FROM MAPS AND DEEDS AND OTHER INFORMATION OF PUBLIC RECORD. IN ACCORDANCE WITH THE PROVISIONS OF THE REAL PROPERTY TAX LAW, FOR ASSESSMENT PURPOSES ONLY.
 IT DOES NOT REPRESENT A LAND SURVEY AND MUST NOT BE CONSTRUED AS SUCH.
 DESCRIPTIONS OF REAL PROPERTY TAKEN HEREFROM FOR THE PURPOSE OF CONVEYANCE OR TRANSFER MUST BE LIMITED TO THOSE NECESSARY AND INCIDENTAL TO THE ADMINISTRATION OF THE REAL PROPERTY TAX LAW.

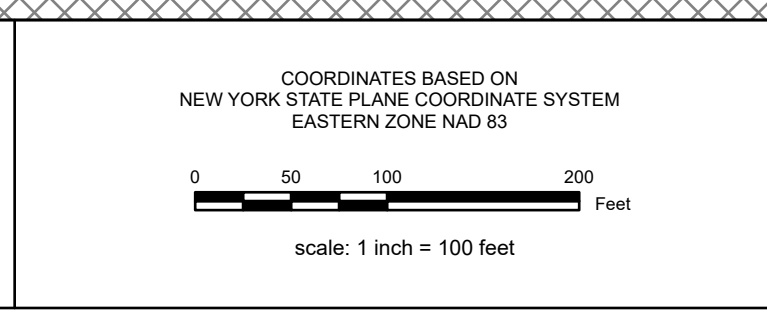

SPECIAL DISTRICTS	
SCHOOL: SHENENGOVA CENTRAL 41262	FIRE: CLIFTON PARK-HALFMOON FIRE FD03 HALFMOON WATERFORD FIRE FD05 HALFMOON FIRE #1 FD02
WATER: CONSOLIDATED WT DIST ZONE 3 WT040	LIGHT:
AG:	PARK:
LAKE:	SEWER:

PROPERTY LINE		LEGEND	
PROPERTY LINE	---	GREAT LOT NUMBER	①
BLOCK LIMIT	---	TAX MAP BLOCK NUMBER	②
SECTION LIMIT	---	FILED PLAN LOT NUMBER	③
TOWN VILLAGE CITY	---	TAX MAP PARCEL NUMBER	④
COUNTY LINE	---	STREAM/WATERBODY	⑤
RAILROAD	---	DENOTES COMMON OWNER	⑥

CALCULATED ACREAGE	
267.17	267.18
273.00	273.07
273.00	273.00

TAX MAP 273.06
TOWN OF HALFMOON
 SARATOGA COUNTY, NEW YORK
 TAXABLE STATUS DATE: March 1, 2028
 MAP EXPORTED ON: March 20, 2028