

**REAL PROPERTY TAX MAP**  
 PREPARED FOR: SARATOGA COUNTY BOARD OF SUPERVISORS  
 UNDER SUPERVISION OF: REAL PROPERTY TAX SERVICE AGENCY  
 PREPARED BY: L. ROBERT KIMBALL CONSULTING ENGINEERS, EBENSBURG, PA (1973-1978)  
 CONVERTED TO DIGITAL FORMAT BY THE L.A. GROUPE SARATOGA SPRINGS, NY (1986-1998)  
 CONVERTED TO DIGITAL FORMAT FROM NAD 27 TO NAD 83 BY WILSON MAPPING, INC. (2002)  
 CONVERTED TO ESRI GEDATABASE FORMAT BY FOUNTAINS SPITAL, INC. (2007-2008)

THIS MAP HAS BEEN PREPARED FROM MAPS AND DEEDS AND OTHER INFORMATION OF PUBLIC RECORD. IN ACCORDANCE WITH THE PROVISIONS OF THE REAL PROPERTY TAX LAW, FOR ASSESSMENT PURPOSES ONLY.  
 IT DOES NOT REPRESENT A LAND SURVEY AND MUST NOT BE CONSTRUED AS SUCH.  
 DESCRIPTIONS OF REAL PROPERTY TAKEN HEREFROM FOR THE PURPOSE OF CONVEYANCE OR TRANSFER MUST BE LIMITED TO THOSE NECESSARY AND INCIDENTAL TO THE ADMINISTRATION OF THE REAL PROPERTY TAX LAW.

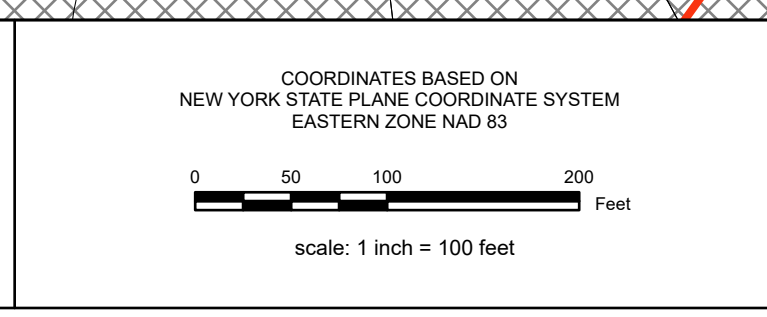

| SPECIAL DISTRICTS                        |                                       |
|--|---------------------------------------|
| SCHOOL: SHENENDEKWA CENTRAL 41242        | FIRE: CLIFTON PARK-HALFMOON FIRE FD03 |
| WATER: CONSOLIDATED WT DIST ZONE 3 WT040 | LIGHT:                                |
| AG:                                      | PARK:                                 |
| LAKE:                                    | SEWER:                                |

| PROPERTY LINE     |                      |
|-------------------|----------------------|
| BLOCK LIMIT       | GREAT LOT LINE       |
| SECTION LIMIT     | SUBDIVISION LOT LINE |
| TOWN/VILLAGE CITY | STATE ROUTE          |
| COUNTY LINE       | COUNTY ROUTE         |
| RAILROAD          | STREET OR TOWN ROAD  |

| LEGEND                |     |
|-----------------------|-----|
| SCHOOL DISTRICT LINE  | --- |
| FIRE DISTRICT LINE    | --- |
| WATER DISTRICT LINE   | --- |
| AGRICULTURAL DISTRICT | --- |
| LIGHT DISTRICT        | --- |
| NAD 83 TIC LINES      | +   |

| GREAT LOT NUMBER      |            |
|-----------------------|------------|
| TAX MAP BLOCK NUMBER  | ①          |
| FILED PLAN LOT NUMBER | (1)        |
| TAX MAP PARCEL NUMBER | 160.00-3-9 |
| STREAM/WATERBODY      | ~          |

| CALCULATED ACREAGE    |           |
|-----------------------|-----------|
| DEED ACREAGE          | 9.8 A (C) |
| SCALED DIMENSION      | 9.8 A     |
| DEED DIMENSION        | 150.2     |
| COORDINATE LOCATOR    | +         |
| IDENTIFY COMMON OWNER | +         |

| SHEET INDEX |        |        |
|-------------|--------|--------|
| 272.00      | 272.16 | 273.00 |
| 272.00      | 273.00 | 273.17 |
| 278.02      | 278.02 | 279.00 |

**TAX MAP 272.20**  
**TOWN OF HALFMOON**  
**SARATOGA COUNTY, NEW YORK**  
 TAXABLE STATUS DATE: March 1, 2028  
 MAP EXPORTED ON: March 20, 2028