

REAL PROPERTY TAX MAP
 PREPARED FOR: SARATOGA COUNTY BOARD OF SUPERVISORS
 UNDER SUPERVISION OF: REAL PROPERTY TAX SERVICE AGENCY
 PREPARED BY:
 L. ROBERT KIMBALL CONSULTING ENGINEERS, EBENSBURG, PA (1973-1978)
 CONVERTED TO DIGITAL FORMAT BY THE L.A. GROUP SARATOGA SPRINGS, NY (1986-1998)
 CONVERTED TO DIGITAL FORMAT FROM NAD 27 TO NAD 83 BY WILSON-MAPPING, INC. (2002)
 CONVERTED TO ESRI GDB/DATABASE FORMAT BY FOUNTAINS SPITAL, INC. (2007-2008)

THIS MAP HAS BEEN PREPARED FROM MAPS AND DEEDS AND OTHER INFORMATION OF PUBLIC RECORD. IN ACCORDANCE WITH THE PROVISIONS OF THE REAL PROPERTY TAX LAW, FOR ASSESSMENT PURPOSES ONLY.
 IT DOES NOT REPRESENT A LAND SURVEY AND MUST NOT BE CONSTRUED AS SUCH.
 DESCRIPTIONS OF REAL PROPERTY TAKEN HEREFROM FOR THE PURPOSE OF CONVEYANCE OR TRANSFER MUST BE LIMITED TO THOSE NECESSARY AND INCIDENTAL TO THE ADMINISTRATION OF THE REAL PROPERTY TAX LAW.

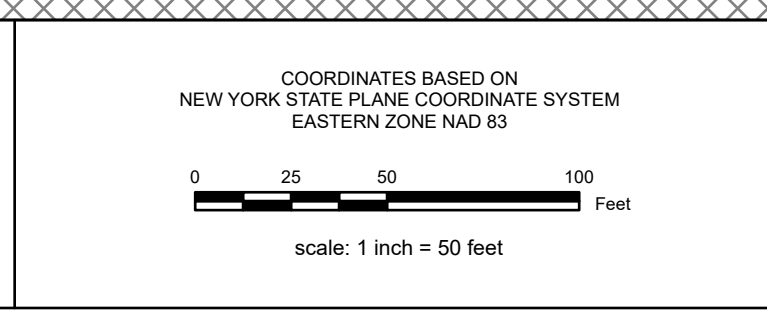

SPECIAL DISTRICTS	
SCHOOL: SHENDEKOWA CENTRAL 41262	PIPE: HALMOON FIRE #1 FM02
WATER: CONSOLIDATED WT DIST ZONE 3 WT00	LIGHT:
AG:	PARK:
LAKE:	SEWER:

PROPERTY LINE		GREAT LOT LINE	
BLOCK LIMIT	---	SUBDIVISION LOT LINE	---
SECTION LIMIT	---	STATE ROUTE	---
TOWN/VILLAGE/CITY	---	COUNTY ROUTE	---
COUNTY LINE	---	STREET OR TOWN ROAD	---
RAILROAD	---	MAIN ST	---

LEGEND	
SCHOOL DISTRICT LINE	---
FIRE DISTRICT LINE	---
WATER DISTRICT LINE	---
AGRICULTURAL DISTRICT	---
LIGHT DISTRICT	---
NAD 83 TIC LINES	---
GREAT LOT NUMBER	①
TAX MAP BLOCK NUMBER	①
FILED PLAN LOT NUMBER	①
TAX MAP PARCEL NUMBER	160.00-3-9
STREAM/WATERBODY	---

CALCULATED ACREAGE	
DEED ACREAGE	9.8 A (C)
SCALED DIMENSION	8.8 A
DEED DIMENSION	150.2 (S)
COORDINATE LOCATOR	+
DENOTES COMMON OWNER	+

SHEET INDEX		
267.00	267.00	267.00
267.18	267.00	267.00
273.00	273.00	273.00

TAX MAP 267.81
TOWN OF HALMOON
 SARATOGA COUNTY, NEW YORK
 TAXABLE STATUS DATE: March 1, 2028
 MAP EXPORTED ON: March 20, 2028