

**REAL PROPERTY TAX MAP**  
 PREPARED FOR: SARATOGA COUNTY BOARD OF SUPERVISORS  
 UNDER SUPERVISION OF: REAL PROPERTY TAX SERVICE AGENCY  
 PREPARED BY: L. ROBERT KIMBALL CONSULTING ENGINEERS, EBENSBURG, PA (1973-1978)  
 CONVERTED TO DIGITAL FORMAT BY THE L.A. GROUP SARATOGA SPRINGS, NY (1986-1998)  
 CONVERTED TO DIGITAL FORMAT FROM NAD 27 TO NAD 83 BY WILSON MAPPING, INC. (2002)  
 CONVERTED TO ESRI GECODATABASE FORMAT BY FOUNTAINS SPITAL, INC. (2007-2008)

THIS MAP HAS BEEN PREPARED FROM MAPS AND DEEDS AND OTHER INFORMATION OF PUBLIC RECORD, IN ACCORDANCE WITH THE PROVISIONS OF THE REAL PROPERTY TAX LAW, FOR ASSESSMENT PURPOSES ONLY.  
 IT DOES NOT REPRESENT A LAND SURVEY AND MUST NOT BE CONSTRUED AS SUCH.  
 DESCRIPTIONS OF REAL PROPERTY TAKEN HEREFROM FOR THE PURPOSE OF CONVEYANCE OR TRANSFER MUST BE LIMITED TO THOSE NECESSARY AND INCIDENTAL TO THE ADMINISTRATION OF THE REAL PROPERTY TAX LAW.

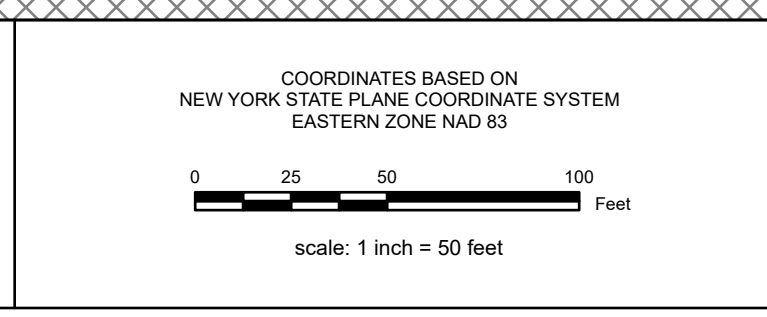

**SPECIAL DISTRICTS**

<b>SCHOOL:</b> HORNVILLE CENTRAL 411000	<b>FIRE:</b> HALFMOON FIRE #1 R002	<b>PROPERTY LINE:</b> Solid line	<b>GREAT LOT LINE:</b> Dashed line	<b>SCHOOL DISTRICT LINE:</b> Dashed line
<b>WATER:</b> CONSOLIDATED WT DIST ZONE 3 WT040	<b>LIGHT:</b> Dashed line	<b>BLOCK LIMIT:</b> Dashed line	<b>SUBDIVISION LOT LINE:</b> Dashed line	<b>FIRE DISTRICT LINE:</b> Dashed line
<b>AG:</b>	<b>PARK:</b> Dashed line	<b>SECTION LIMIT:</b> Dashed line	<b>STATE ROUTE:</b> Dashed line	<b>WATER DISTRICT LINE:</b> Dashed line
<b>LAKE:</b>	<b>SEWER:</b> Dashed line	<b>TOWN VILLAGE CITY:</b> Dashed line	<b>COUNTY ROUTE:</b> Dashed line	<b>AGRICULTURAL DISTRICT:</b> Dashed line
		<b>COUNTY LINE:</b> Dashed line	<b>STREET OR TOWN ROAD:</b> Dashed line	<b>LIGHT DISTRICT:</b> Dashed line
		<b>RAILROAD:</b> Dashed line	<b>MAIN ST:</b> Dashed line	<b>NAD 83 TIC LINES:</b> Dashed line

**LEGEND**

<b>GREAT LOT NUMBER:</b> Circle with number	<b>TAX MAP BLOCK NUMBER:</b> Circle with number	<b>FILED PLAN LOT NUMBER:</b> Circle with number	<b>SCALED DIMENSION:</b> Circle with number	<b>DEED DIMENSION:</b> Circle with number	<b>COORDINATE LOCATOR:</b> Circle with number	<b>DENOTES COMMON OWNER:</b> Circle with number
<b>160.00-3.0</b>						

**SHEET INDEX**

267.00	267.00	267.00
267.00	267.81	267.00
267.18	267.81	267.00

**TAX MAP 267.73**  
**TOWN OF HALFMOON**  
**SARATOGA COUNTY, NEW YORK**  
 TAXABLE STATUS DATE: March 1, 2028  
 MAP EXPORTED ON: March 20, 2028