

**REAL PROPERTY TAX MAP**  
 PREPARED FOR: SARATOGA COUNTY BOARD OF SUPERVISORS  
 UNDER SUPERVISION OF: REAL PROPERTY TAX SERVICE AGENCY  
 PREPARED BY:  
 L. ROBERT KIMBALL CONSULTING ENGINEERS, ERIENBURG, PA (1973-1978)  
 CONVERTED TO DIGITAL FORMAT BY THE L.A. GROUP SARATOGA SPRINGS, NY (1986-1998)  
 CONVERTED TO DIGITAL FORMAT FROM NAD 27 TO NAD 83 BY WILSON MAPPING, INC. (2002)  
 CONVERTED TO ESRI GDB/DATABASE FORMAT BY FOUNTAINS SPITAL, INC. (2007-2008)

THIS MAP HAS BEEN PREPARED FROM MAPS AND DEEDS AND OTHER INFORMATION OF PUBLIC RECORD. IN ACCORDANCE WITH THE PROVISIONS OF THE REAL PROPERTY TAX LAW, FOR ASSESSMENT PURPOSES ONLY.  
 IT DOES NOT REPRESENT A LAND SURVEY AND MUST NOT BE CONSTRUED AS SUCH.  
 DESCRIPTIONS OF REAL PROPERTY TAKEN HEREFROM FOR THE PURPOSE OF CONVEYANCE OR TRANSFER, MUST BE LIMITED TO THOSE NECESSARY AND INCIDENTAL TO THE ADMINISTRATION OF THE REAL PROPERTY TAX LAW.

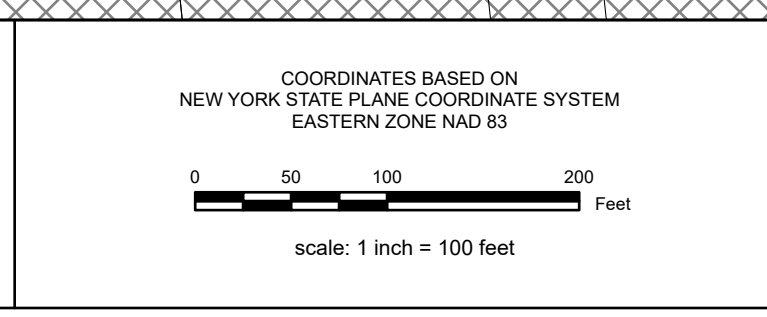

SPECIAL DISTRICTS	
SCHOOL: SHENENDEAWA CENTRAL 41242	FIRE: CLIFTON PARK-HALPOON FIRE FD03
WATER: CONSOLIDATED WT DIST 3 WTR0	LIGHT:
AGE:	PARK:
LAKE:	SEWER:

PROPERTY LINE	
BLOCK LIMIT	SECTION LIMIT
TOWN VILLAGE CITY	COUNTY LINE
COUNTY LINE	RAILROAD

LEGEND	
GREAT LOT LINE	SCHOOL DISTRICT LINE
SUBDIVISION LOT LINE	FIRE DISTRICT LINE
STATE ROUTE	WATER DISTRICT LINE
COUNTY ROUTE	AGRICULTURAL DISTRICT
STREET OR TOWN ROAD	LIGHT DISTRICT
	NAD 83 TIC LINES

GREAT LOT NUMBER	9.8.A (C)
TAX MAP BLOCK NUMBER	8.8.A
FILED PLAN LOT NUMBER	150 (S)
TAX MAP PARCEL NUMBER	150.2
STREAM/WATERBODY	160.00-3.0
	160.00-3.0

CALCULATED ACREAGE	
DEED ACREAGE	9.8.A (C)
SCALED DIMENSION	8.8.A
DEED DIMENSION	150 (S)
COORDINATE LOCATOR	150.2
DENOTES COMMON OWNER	160.00-3.0

**TAX MAP 266.19**  
**TOWN OF HALFMOON**  
**SARATOGA COUNTY, NEW YORK**  
 TAXABLE STATUS DATE: March 1, 2028  
 MAP EXPORTED ON: March 20, 2028

SHEET INDEX	
266.14	266.04
266.18	266.20
272.01	272.02
272.02	272.02