

REAL PROPERTY TAX MAP
 PREPARED FOR: SARATOGA COUNTY BOARD OF SUPERVISORS
 UNDER SUPERVISION OF: REAL PROPERTY TAX SERVICE AGENCY
 PREPARED BY:
 L. ROBERT KIMBALL CONSULTING ENGINEERS, EBENSBURG, PA (1973-1978)
 CONVERTED TO DIGITAL FORMAT BY THE L.A. GROUP SARATOGA SPRINGS, NY (1986-1998)
 CONVERTED TO DIGITAL FORMAT FROM NAD 27 TO NAD 83 BY WILSON MAPPING, INC. (2002)
 CONVERTED TO ESRI GDB/DATABASE FORMAT BY FOUNTAINS SPITAL, INC. (2007-2008)

THIS MAP HAS BEEN PREPARED FROM MAPS AND DEEDS AND OTHER INFORMATION OF PUBLIC RECORD. IN ACCORDANCE WITH THE PROVISIONS OF THE REAL PROPERTY TAX LAW, FOR ASSESSMENT PURPOSES ONLY.
 IT DOES NOT REPRESENT A LAND SURVEY AND MUST NOT BE CONSTRUED AS SUCH.
 DESCRIPTIONS OF REAL PROPERTY TAKEN HEREFROM FOR THE PURPOSE OF CONVEYANCE OR TRANSFER MUST BE LIMITED TO THOSE NECESSARY AND INCIDENTAL TO THE ADMINISTRATION OF THE REAL PROPERTY TAX LAW.

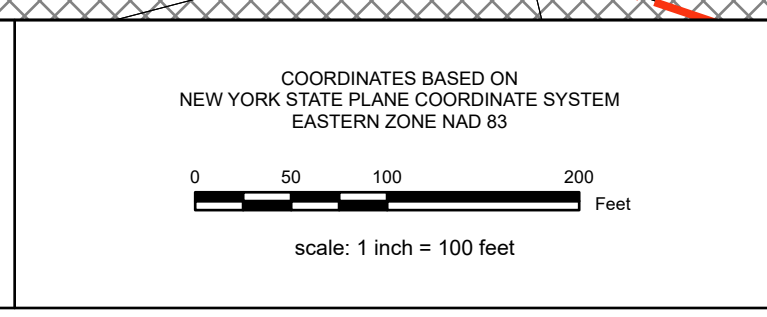

SPECIAL DISTRICTS	
SCHOOL: SHENDEKOWA CENTRAL 41242	FIRE: CLIFTON PARK-HALFMOON FIRE FD03
WATER: CONSOLIDATED WT DIST ZONE 3 WT040	LIGHT:
AG:	PARK:
LAKE:	SEWER:

PROPERTY LINE	
BLOCK LIMIT	GREAT LOT LINE
SECTION LIMIT	SUBDIVISION LOT LINE
TOWN/VILLAGE/CITY	STATE ROUTE
COUNTY LINE	COUNTY ROUTE
RAILROAD	STREET OR TOWN ROAD
	MAIN ST

LEGEND	
SCHOOL DISTRICT LINE	GREAT LOT NUMBER
FIRE DISTRICT LINE	TAX MAP BLOCK NUMBER
WATER DISTRICT LINE	FILED PLAN LOT NUMBER
AGRICULTURAL DISTRICT	TAX MAP PARCEL NUMBER
LIGHT DISTRICT	160.00-3.0
NAD 83 TIC LINES	STREAM/WATERBODY

CALCULATED ACREAGE	
DEED ACREAGE	9.8 A (C)
SCALED DIMENSION	9.8 A
DEED DIMENSION	150 (S)
COORDINATE LOCATOR	150.2
IDENTIFIES COMMON OWNER	

SHEET INDEX			
266.00	266.01	266.02	266.03
266.00	266.00	266.04	266.04

TAX MAP 266.10
TOWN OF HALFMOON
SARATOGA COUNTY, NEW YORK
 TAXABLE STATUS DATE: March 1, 2028 MAP EXPORTED ON: March 20, 2028