

REAL PROPERTY TAX MAP
 PREPARED FOR: SARATOGA COUNTY BOARD OF SUPERVISORS
 UNDER SUPERVISION OF: REAL PROPERTY TAX SERVICE AGENCY
 PREPARED BY: L. ROBERT KIMBALL CONSULTING ENGINEERS, ERIEBURG, PA (1973-1978)
 CONVERTED TO DIGITAL FORMAT BY THE L. GROUP SARATOGA SPRINGS, NY (1998-1999)
 CONVERTED TO DIGITAL FORMAT FROM NAD 27 TO NAD 83 BY WILSON MAPING, INC. (2002)
 CONVERTED TO ESRI GDB/DATABASE FORMAT BY FOUNTAINS SPATIAL, INC. (2007-2008)

THIS MAP HAS BEEN PREPARED FROM MAPS AND DEEDS AND OTHER INFORMATION OF PUBLIC RECORD. IN ACCORDANCE WITH THE PROVISIONS OF THE REAL PROPERTY TAX LAW, FOR ASSESSMENT PURPOSES ONLY.
 IT DOES NOT REPRESENT A LAND SURVEY AND MUST NOT BE CONSTRUED AS SUCH.
 DESCRIPTIONS OF REAL PROPERTY TAKEN HEREFROM FOR THE PURPOSE OF CONVEYANCE OR TRANSFER, MUST BE LIMITED TO THOSE NECESSARY AND INCIDENTAL TO THE ADMINISTRATION OF THE REAL PROPERTY TAX LAW.

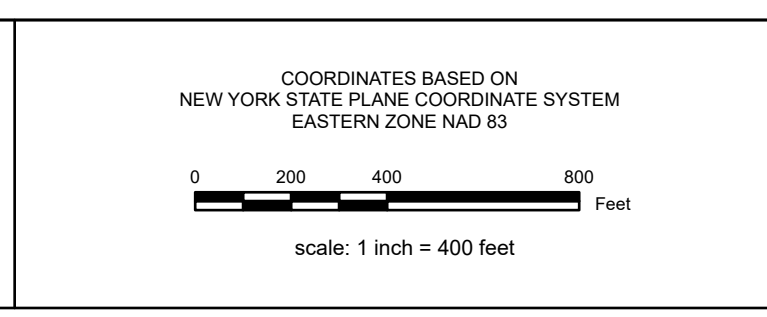

SPECIAL DISTRICTS	
SCHOOL: SARATOGA SPRINGS CENTRAL 41300	WATER:
FIRE: GREENFIELD-WILTON FIRE 70006	LIGHT:
AG:	SEWER:
LAKE:	PARK:

PROPERTY LINE	
BLOCK LIMIT	GREAT LOT LINE
SECTION LIMIT	SUBDIVISION LOT LINE
TOWN/VILLAGE/CITY	STATE ROUTE
COUNTY LINE	COUNTY ROUTE
RAILROAD	STREET OR TOWN ROAD

LEGEND	
SCHOOL DISTRICT LINE	WATER
FIRE DISTRICT LINE	WATER DISTRICT LINE
AGRICULTURAL DISTRICT	LIGHT DISTRICT
NAD 83 TIC LINES	

GREAT LOT NUMBER	TAX MAP BLOCK NUMBER	CALCULATED ACREAGE	9.8 A (C)
FILED PLAN LOT NUMBER	TAX MAP PARCEL NUMBER	SCALED DIMENSION	8.8 A
STREAM/WATERBODY	160.00-3.9	COORDINATE LOCATOR	150 (S)
		DENOTES COMMON OWNER	164.00

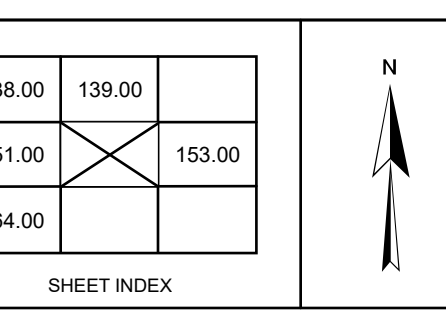

TAX MAP **152.00**
TOWN OF GREENFIELD
SARATOGA COUNTY, NEW YORK
 TAXABLE STATUS DATE: March 1, 2028
 MAP EXPORTED ON: March 12, 2028