

REAL PROPERTY TAX MAP
 PREPARED FOR: SARATOGA COUNTY BOARD OF SUPERVISORS
 UNDER SUPERVISION OF: REAL PROPERTY TAX SERVICE AGENCY
 PREPARED BY:
 L. ROBERT KIMBALL CONSULTING ENGINEERS, EBENSBURG, PA (1973-1978)
 CONVERTED TO DIGITAL FORMAT BY THE L.A. GROUP SARATOGA SPRINGS, NY (1986-1998)
 CONVERTED TO DIGITAL FORMAT FROM NAD 27 TO NAD 83 BY WILSON MAPPING, INC. (2002)
 CONVERTED TO ESRI GDB/DATABASE FORMAT BY FOUNTAINS SPITAL, INC. (2007-2008)

THIS MAP HAS BEEN PREPARED FROM MAPS AND DEEDS AND OTHER INFORMATION OF PUBLIC RECORD. IN ACCORDANCE WITH THE PROVISIONS OF THE REAL PROPERTY TAX LAW, FOR ASSESSMENT PURPOSES ONLY.
 IT DOES NOT REPRESENT A LAND SURVEY AND MUST NOT BE CONSIDERED AS SUCH.
 DESCRIPTIONS OF REAL PROPERTY TAKEN HEREFROM FOR THE PURPOSE OF CONVEYANCE OR TRANSFER, MUST BE LIMITED TO THOSE NECESSARY AND INCIDENTAL TO THE ADMINISTRATION OF THE REAL PROPERTY TAX LAW.

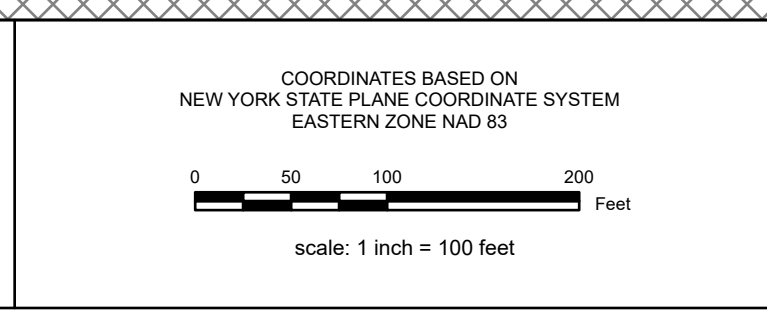

SPECIAL DISTRICTS
 SCHOOL: SARATOGA SPRINGS CENTRAL 411500
 FIRE: GREENFIELD-HILTON FIRE 70006
 AG:
 LAKE:

PROPERTY LINE
 BLOCK LIMIT
 SECTION LIMIT
 TOWN/VILLAGE/CITY
 COUNTY LINE
 RAILROAD

LEGEND
 GREAT LOT LINE
 SUBDIVISION LOT LINE
 STATE ROUTE
 COUNTY ROUTE
 STREET OR TOWN ROAD
 SCHOOL DISTRICT LINE
 FIRE DISTRICT LINE
 WATER DISTRICT LINE
 AGRICULTURAL DISTRICT
 LIGHT DISTRICT
 NAD 83 TIC LINES

LEGEND
 GREAT LOT NUMBER
 TAX MAP BLOCK NUMBER
 FILED PLAN LOT NUMBER
 TAX MAP PARCEL NUMBER
 STREAM/WATERBODY
 DENOTES COMMON OWNER

LEGEND
 CALCULATED ACREAGE
 DEED ACREAGE
 SCALED DIMENSION
 DEED DIMENSION
 COORDINATE LOCATOR
 DENOTES COMMON OWNER

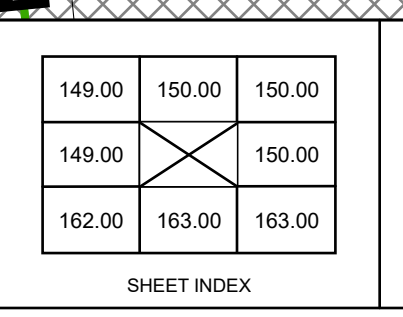

TAX MAP 150.17
TOWN OF GREENFIELD
SARATOGA COUNTY, NEW YORK
 TAXABLE STATUS DATE: March 1, 2028
 MAP EXPORTED ON: March 12, 2028