

**REAL PROPERTY TAX MAP**  
 PREPARED FOR: SARATOGA COUNTY BOARD OF SUPERVISORS  
 UNDER SUPERVISION OF: REAL PROPERTY TAX SERVICE AGENCY  
 PREPARED BY: L. ROBERT KIMBALL CONSULTING ENGINEERS, EBENSBURG, PA (1973-1978)  
 CONVERTED TO DIGITAL FORMAT BY THE L.A. GROUP SARATOGA SPRINGS, NY (1996-1998)  
 CONVERTED TO DIGITAL FORMAT FROM NAD 27 TO NAD 83 BY WELLES-MAPPING, INC. (2002)  
 CONVERTED TO ESRI GEODATABASE FORMAT BY FOUNTAINS SPATIAL, INC. (2007-2008)

THIS MAP HAS BEEN PREPARED FROM MAPS AND DEEDS AND OTHER INFORMATION OF PUBLIC RECORD. IN ACCORDANCE WITH THE PROVISIONS OF THE REAL PROPERTY TAX LAW, FOR ASSESSMENT PURPOSES ONLY.  
 IT DOES NOT REPRESENT A LAND SURVEY AND MUST NOT BE CONSTRUED AS SUCH.  
 DESCRIPTIONS OF REAL PROPERTY TAKEN HEREFROM FOR THE PURPOSE OF CONVEYANCE OR TRANSFER, MUST BE LIMITED TO THOSE NECESSARY AND INCIDENTAL TO THE ADMINISTRATION OF THE REAL PROPERTY TAX LAW.

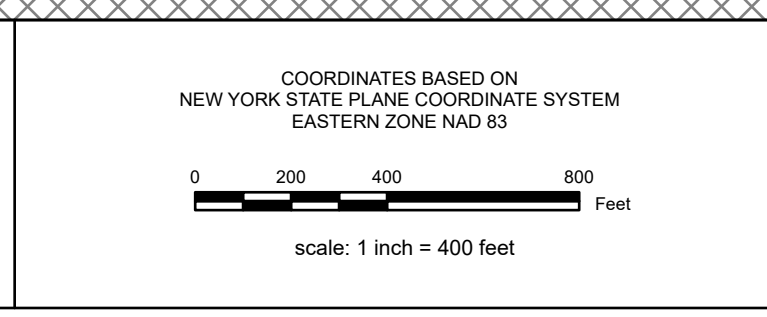

**SPECIAL DISTRICTS**  
 SCHOOL: SARATOGA SPRINGS CENTRAL 412300  
 CORINTH CENTRAL 412601  
 FIRE: GREENFIELD-WILTON FIRE 70066  
 AG:  
 LAKE:

**PROPERTY LINE**  
 BLOCK LIMIT  
 SECTION LIMIT  
 TOWN/VILLAGE/CITY  
 COUNTY LINE  
 RAILROAD

**LEGEND**  
 GREAT LOT LINE  
 SUBDIVISION LOT LINE  
 STATE ROUTE  
 COUNTY ROUTE  
 STREET OR TOWN ROAD  
 SCHOOL DISTRICT LINE  
 FIRE DISTRICT LINE  
 WATER DISTRICT LINE  
 AGRICULTURAL DISTRICT  
 LIGHT DISTRICT  
 NAD 83 TIC LINES

GREAT LOT NUMBER  
 TAX MAP BLOCK NUMBER  
 FILED PLAN LOT NUMBER  
 TAX MAP PARCEL NUMBER  
 STREAM/WATERBODY

CALCULATED ACREAGE  
 DEED ACREAGE  
 SCALED DIMENSION  
 DEED DIMENSION  
 COORDINATE LOCATOR  
 DENOTES COMMON OWNER

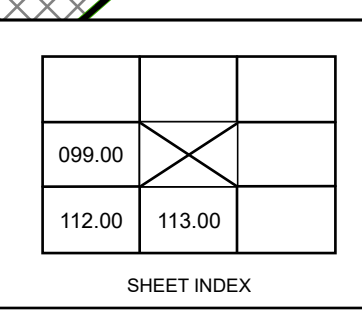

**TAX MAP** 100.00  
**TOWN OF GREENFIELD**  
**SARATOGA COUNTY, NEW YORK**  
 TAXABLE STATUS DATE: March 1, 2028 MAP EXPORTED ON: March 12, 2028