

REAL PROPERTY TAX MAP
 SARATOGA COUNTY BOARD OF SUPERVISORS
 UNDER SUPERVISION OF: REAL PROPERTY TAX SERVICE AGENCY
 PREPARED BY:
 L. ROBERT KIMBALL CONSULTING ENGINEERS, EDINBURG, PA (1973-1978)
 CONVERTED TO DIGITAL FORMAT BY THE L.A. GROUP SARATOGA SPRINGS, NY (1986-1998)
 CONVERTED TO DIGITAL FORMAT FROM NAD 27 TO NAD 83 BY WILSON MAPPING, INC. (2002)
 CONVERTED TO ESRI GECODATABASE FORMAT BY FOUNTAINS SPITAL, INC. (2007-2008)

THIS MAP HAS BEEN PREPARED FROM MAPS AND DEEDS AND OTHER INFORMATION OF PUBLIC RECORD, IN ACCORDANCE WITH THE PROVISIONS OF THE REAL PROPERTY TAX LAW, FOR ASSESSMENT PURPOSES ONLY.
 IT DOES NOT REPRESENT A LAND SURVEY AND MUST NOT BE CONSTRUED AS SUCH.
 DESCRIPTIONS OF REAL PROPERTY TAKEN HEREFROM FOR THE PURPOSE OF CONVEYANCE OR TRANSFER MUST BE LIMITED TO THOSE NECESSARY AND INCIDENTAL TO THE ADMINISTRATION OF THE REAL PROPERTY TAX LAW.

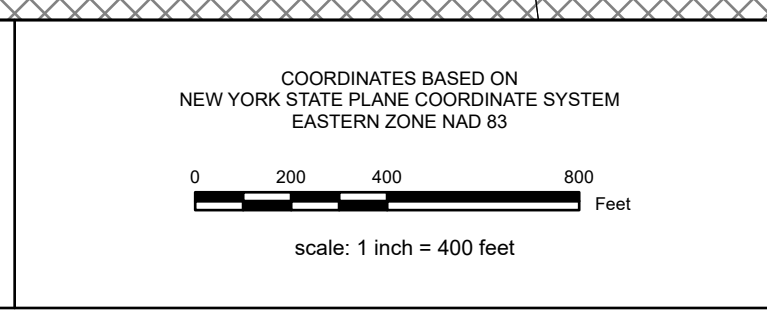

SPECIAL DISTRICTS	
AG:	LAKE:
FIRE: EDINBURG FIRE FD019	WATER:
SCHOOL: EDINBURG CONSOLIDATED 413001	LIGHT:
SEWER:	PARK:

PROPERTY LINE	
BLOCK LIMIT	GREAT LOT LINE
SECTION LIMIT	SUBDIVISION LOT LINE
TOWN/VILLAGE/CITY	STATE ROUTE
COUNTY LINE	COUNTY ROUTE
RAILROAD	STREET OR TOWN ROAD

LEGEND	
SCHOOL DISTRICT LINE	TAX MAP BLOCK NUMBER
FIRE DISTRICT LINE	TAX MAP PLAN LOT NUMBER
WATER DISTRICT LINE	TAX MAP PARCEL NUMBER
AGRICULTURAL DISTRICT	STREAM/WATERBODY
LIGHT DISTRICT	
NAD 83 TIC LINES	

CALCULATED ACREAGE	
DEED ACREAGE	9.8 A (C)
SCALED DIMENSION	8.8 A
DEED DIMENSION	150.2 (S)
COORDINATE LOCATOR	150.2 (S)
DENOTES COMMON OWNER	

SHEET INDEX		
081.00	082.00	083.00
094.00	095.00	096.00
107.00	108.00	109.00

TAX MAP 095.00
TOWN OF EDINBURG
SARATOGA COUNTY, NEW YORK
 TAXABLE STATUS DATE: March 1, 2028
 MAP EXPORTED ON: March 17, 2028