

PART OF
81.00-1-1
MATCH LINE
MATCH LINE

081.00

REAL PROPERTY TAX MAP
SARATOGA COUNTY BOARD OF SUPERVISORS
PREPARED FOR:
UNDER SUPERVISION OF: REAL PROPERTY TAX SERVICE AGENCY
PREPARED BY:
L. ROBERT KIMBALL CONSULTING ENGINEERS, EBENSBURG, PA (1973-1978)
CONVERTED TO DIGITAL FORMAT BY THE L.A. GROUP SARATOGA SPRINGS, NY (1986-1998)
CONVERTED TO DIGITAL FORMAT FROM NAD 27 TO NAD 83 BY WELLS & WAPPING, INC. (2002)
CONVERTED TO ESRI GDB/DATABASE FORMAT BY FOUNTAINS SPITAL, INC. (2007-2008)

THIS MAP HAS BEEN PREPARED FROM MAPS AND DEEDS AND OTHER INFORMATION OF PUBLIC RECORD, IN ACCORDANCE WITH THE PROVISIONS OF THE REAL PROPERTY TAX LAW, FOR ASSESSMENT PURPOSES ONLY.
IT DOES NOT REPRESENT A LAND SURVEY AND MUST NOT BE CONSTRUED AS SUCH.
DESCRIPTIONS OF REAL PROPERTY TAKEN HEREFROM FOR THE PURPOSE OF CONVEYANCE OR TRANSFER MUST BE LIMITED TO THOSE NECESSARY AND INCIDENTAL TO THE ADMINISTRATION OF THE REAL PROPERTY TAX LAW.

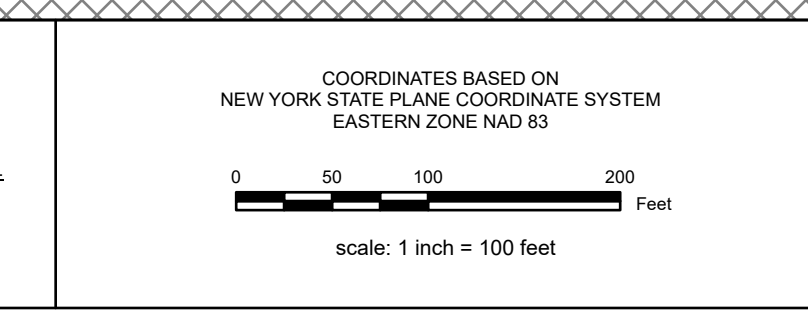

| SPECIAL DISTRICTS | |
|-------------------------------------|--------|
| AGI: | LAKE: |
| FIRE: EDINBURG FIRE 10019 | WATER: |
| SCHOOL: EDINBURG CONSOLIDATED 41301 | LIGHT: |
| SEWER: | PARK: |

| PROPERTY LINE | |
|-------------------|----------------------|
| BLOCK LIMIT | GREAT LOT LINE |
| SECTION LIMIT | SUBDIVISION LOT LINE |
| TOWN/VILLAGE/CITY | STATE ROUTE |
| COUNTY LINE | COUNTY ROUTE |
| RAILROAD | STREET OR TOWN ROAD |
| | MAIN ST |

| LEGEND | |
|-----------------------|-----------------------|
| SCHOOL DISTRICT LINE | WATER DISTRICT LINE |
| FIRE DISTRICT LINE | AGRICULTURAL DISTRICT |
| WATER DISTRICT LINE | LIGHT DISTRICT |
| AGRICULTURAL DISTRICT | NAD 83 TIC LINES |
| LIGHT DISTRICT | |
| NAD 83 TIC LINES | |

| | | |
|-----------------------|-----------------------|----------------------|
| GREAT LOT NUMBER | TAX MAP BLOCK NUMBER | 9.8 A (C) |
| FILED PLAN LOT NUMBER | TAX MAP PARCEL NUMBER | 9.8 A |
| STREAM/WATERBODY | 160.00-3-9 | 150.2 (S) |
| | | 150.2 |
| | | COORDINATE LOCATOR |
| | | DENOTES COMMON OWNER |

| SHEET INDEX | | | |
|-------------|--------|--------|--|
| 080.00 | 080.00 | 081.00 | |
| 080.00 | | 081.00 | |
| 080.00 | 080.20 | 081.00 | |

TAX MAP 080.16
TOWN OF EDINBURG
SARATOGA COUNTY, NEW YORK
TAXABLE STATUS DATE: March 1, 2028
MAP EXPORTED ON: March 17, 2028