

REAL PROPERTY TAX MAP
 PREPARED FOR: SARATOGA COUNTY BOARD OF SUPERVISORS
 UNDER SUPERVISION OF: REAL PROPERTY TAX SERVICE AGENCY
 PREPARED BY:
 L. ROBERT KIMBALL CONSULTING ENGINEERS, EDINBURG, PA (1973-1978)
 CONVERTED TO DIGITAL FORMAT BY THE L.A. GROUP SARATOGA SPRINGS, NY (1986-1998)
 CONVERTED TO DIGITAL FORMAT FROM NAD 27 TO NAD 83 BY WILSON-MAPPING, INC. (2002)
 CONVERTED TO ESRI GECODATABASE FORMAT BY FOUNTAINS SPITAL, INC. (2007-2008)

THIS MAP HAS BEEN PREPARED FROM MAPS AND DEEDS AND OTHER INFORMATION OF PUBLIC RECORD, IN ACCORDANCE WITH THE PROVISIONS OF THE REAL PROPERTY TAX LAW, FOR ASSESSMENT PURPOSES ONLY.
 IT DOES NOT REPRESENT A LAND SURVEY AND MUST NOT BE CONSTRUED AS SUCH.
 DESCRIPTIONS OF REAL PROPERTY TAKEN HEREFROM FOR THE PURPOSE OF CONVEYANCE OR TRANSFER, MUST BE LIMITED TO THOSE NECESSARY AND INCIDENTAL TO THE ADMINISTRATION OF THE REAL PROPERTY TAX LAW.

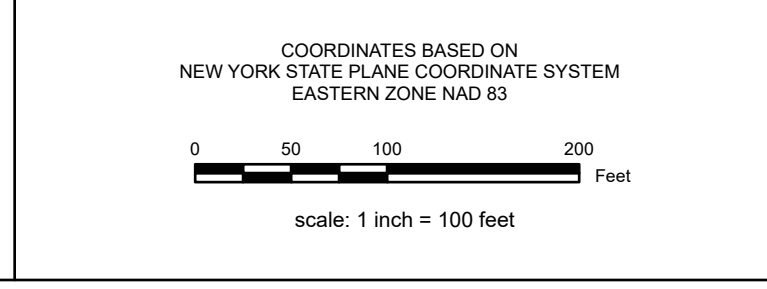

SPECIAL DISTRICTS	
AG: EDINBURG FIRE 10039	WATER: EDINBURG CONSOLIDATED 41300
FIRE: EDINBURG FIRE 10039	SEWER: EDINBURG CONSOLIDATED 41300
SCHOOL: EDINBURG CONSOLIDATED 41300	

PROPERTY LINE	
PROPERTY LINE	---
BLOCK LIMIT	---
SECTION LIMIT	---
TOWN/VILLAGE/CITY	---
COUNTY LINE	---
RAILROAD	---

LEGEND	
GREAT LOT LINE	---
SUBDIVISION LOT LINE	---
STATE ROUTE	---
COUNTY ROUTE	---
STREET OR TOWN ROAD	---
SCHOOL DISTRICT LINE	---
FIRE DISTRICT LINE	---
WATER DISTRICT LINE	---
AGRICULTURAL DISTRICT	---
LIGHT DISTRICT	---
NAD 83 TIC LINES	---
STREAM/WATERBODY	---
MAIN ST	---

GREAT LOT NUMBER	
TAX MAP BLOCK NUMBER	---
FILED PLAN LOT NUMBER	---
TAX MAP PARCEL NUMBER	---
STREAM/WATERBODY	---

CALCULATED ACREAGE	
9.9 A (C)	---
9.8 A	---
150 (S)	---
150.2	---
COORDINATE LOCATOR	---
DENOTES COMMON OWNER	---

SHEET INDEX	
067.00	068.00
067.00	068.00
067.00	068.13
068.00	068.00

TAX MAP 068.09
TOWN OF EDINBURG
SARATOGA COUNTY, NEW YORK
 TAXABLE STATUS DATE: March 1, 2028
 MAP EXPORTED ON: March 17, 2028