

REAL PROPERTY TAX MAP
 PREPARED FOR: SARATOGA COUNTY BOARD OF SUPERVISORS
 UNDER SUPERVISION OF: REAL PROPERTY TAX SERVICE AGENCY
 PREPARED BY:
 L. ROBERT KIMBALL CONSULTING ENGINEERS, EDBURG, PA (1973-1978)
 CONVERTED TO DIGITAL FORMAT BY THE L.A. GROUP SARATOGA SPRINGS, NY (1998-1999)
 CONVERTED TO DIGITAL FORMAT FROM NAD 27 TO NAD 83 BY WILSON-MAPPING, INC. (2002)
 CONVERTED TO ESRI GEODATABASE FORMAT BY FOUNTAINS SPATIAL, INC. (2007-2008)

THIS MAP HAS BEEN PREPARED FROM MAPS AND DEEDS AND OTHER INFORMATION OF PUBLIC RECORD. IN ACCORDANCE WITH THE PROVISIONS OF THE REAL PROPERTY TAX LAW, FOR ASSESSMENT PURPOSES ONLY.
 IT DOES NOT REPRESENT A LAND SURVEY AND MUST NOT BE CONSTRUED AS SUCH.
 DESCRIPTIONS OF REAL PROPERTY TAKEN HEREFROM FOR THE PURPOSE OF CONVEYANCE OR TRANSFER MUST BE LIMITED TO THOSE NECESSARY AND INCIDENTAL TO THE ADMINISTRATION OF THE REAL PROPERTY TAX LAW.

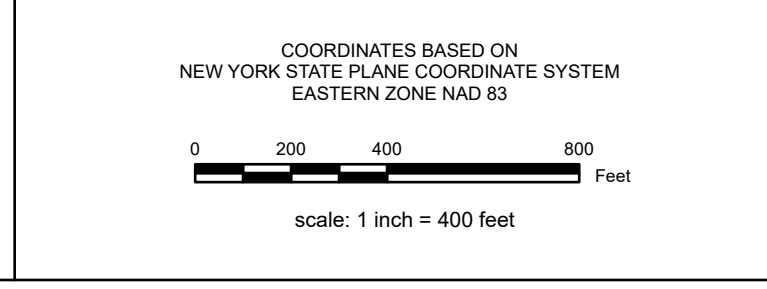

SPECIAL DISTRICTS	
SCHOOL: EDBURG CONSOLIDATED 413001 HADLEY LUZINE CENTRAL 523201	LIGHT:
FIRE: FIRE PROTECTION #2 F5042	PARK:
AD:	SEWER:
LAKE:	WATER:

PROPERTY LINE		LEGEND	
SUBDIVISION LOT LINE	GREAT LOT LINE	SCHOOL DISTRICT LINE	TAX MAP BLOCK NUMBER
BLOCK LIMIT	STATE ROUTE	FIRE DISTRICT LINE	FILED PLAN LOT NUMBER
SECTION LIMIT	COUNTY ROUTE	WATER DISTRICT LINE	TAX MAP PARCEL NUMBER
TOWN VILLAGE CITY	STREET OR TOWN ROAD	AGRICULTURAL DISTRICT	STREAM WATERBODY
COUNTY LINE	RAILROAD	LIGHT DISTRICT	
		NAD 83 TIC LINES	

CALCULATED ACREAGE		COORDINATE LOCATOR	
DEED ACREAGE	8.8 A (C)	DEPT OF ENVIRONMENTAL CONSERVATION	160.00-3.9
SCALED DIMENSION	8.8 A	DEPT OF TAXATION	
DEED DIMENSION	150.2		
COORDINATE LOCATOR	150.2		
DENOTES COMMON OWNER			

SHEET INDEX	
030.00	031.00
042.00	041.00
054.00	055.00

TAX MAP 041.00
TOWN OF DAY
SARATOGA COUNTY, NEW YORK
 TAXABLE STATUS DATE: March 1, 2028
 MAP EXPORTED ON: March 17, 2028