

PART OF
43.00-2-2
FOR REMAINDER
SEE 33.00

FOR REMAINDER
SEE 32.00
PART OF
43.00-2-2

MATCH LINE
MATCH LINE

PART OF
43.00-2-2
MATCH LINE
MATCH LINE
FOR REMAINDER
SEE 32.00

043.00

033.00

044.00

032.16

Great
Sacandaga
032.00
Lake

32.20
①

032.19

REAL PROPERTY TAX MAP
PREPARED FOR: SARATOGA COUNTY BOARD OF SUPERVISORS
UNDER SUPERVISION OF: REAL PROPERTY TAX SERVICE AGENCY

THIS MAP HAS BEEN PREPARED FROM MAPS AND DEEDS AND OTHER INFORMATION OF PUBLIC RECORD, IN ACCORDANCE WITH THE PROVISIONS OF THE REAL PROPERTY TAX LAW, FOR ASSESSMENT PURPOSES ONLY.
IT DOES NOT REPRESENT A LAND SURVEY AND MUST NOT BE CONSTRUED AS SUCH.
DESCRIPTIONS OF REAL PROPERTY TAKEN HEREFROM FOR THE PURPOSE OF CONVEYANCE OR TRANSFER MUST BE LIMITED TO THOSE NECESSARY AND INCIDENTAL TO THE ADMINISTRATION OF THE REAL PROPERTY TAX LAW.

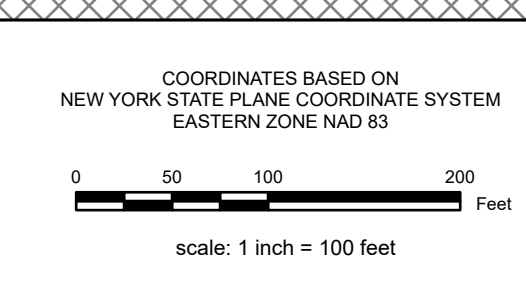

SPECIAL DISTRICTS	
SCHOOL: HADLEY LUTHER CENTRAL 52301	LIGHT:
FIRE: FIRE PROTECTION #1 F5041	PARK:
AD:	SEWER:
LAKE:	WATER:

PROPERTY LINE	
BLOCK LIMIT	SECTION LIMIT
TOWN VILLAGE CITY	COUNTY LINE
RAILROAD	

GREAT LOT LINE	
SUBDIVISION LOT LINE	STATE ROUTE
COUNTY ROUTE	STREET OR TOWN ROAD

SCHOOL DISTRICT LINE	
FIRE DISTRICT LINE	WATER DISTRICT LINE
AGRICULTURAL DISTRICT	LIGHT DISTRICT
NAD 83 TIC LINES	

GREAT LOT NUMBER	
TAX MAP BLOCK NUMBER	FILED PLAN LOT NUMBER
TAX MAP PARCEL NUMBER	STREAM/WATERBODY

CALCULATED ACRES	
DEED ACRES	SCALED DIMENSION
DEED DIMENSION	COORDINATE LOCATOR
DENOTES COMMON OWNER	

SHEET INDEX		
032.00	032.16	033.00
032.19		033.17
043.00	043.00	044.00

TAX MAP	
032.20	

TOWN OF DAY
SARATOGA COUNTY, NEW YORK
TAXABLE STATUS DATE: March 1, 2028
MAP EXPORTED ON: March 17, 2028