

REAL PROPERTY TAX MAP
 PREPARED FOR: SARATOGA COUNTY BOARD OF SUPERVISORS
 UNDER SUPERVISION OF: REAL PROPERTY TAX SERVICE AGENCY
 PREPARED BY:
 L. ROBERT KIMBALL CONSULTING ENGINEERS, EBBENBURG, PA (1973-1978)
 CONVERTED TO DIGITAL FORMAT BY THE L.A. GROUP SARATOGA SPRINGS, NY (1986-1998)
 CONVERTED TO DIGITAL FORMAT FROM NAD 27 TO NAD 83 BY WILHELMSPRING, INC. (2002)
 CONVERTED TO ESRI GECODATABASE FORMAT BY FOUNTAINS SPATIAL, INC. (2007-2008)

THIS MAP HAS BEEN PREPARED FROM MAPS AND DEEDS AND OTHER INFORMATION OF PUBLIC RECORD. IN ACCORDANCE WITH THE PROVISIONS OF THE REAL PROPERTY TAX LAW, FOR ASSESSMENT PURPOSES ONLY.
 IT DOES NOT REPRESENT A LAND SURVEY AND MUST NOT BE CONSTRUED AS SUCH.
 DESCRIPTIONS OF REAL PROPERTY TAKEN HEREFROM FOR THE PURPOSE OF CONVEYANCE OR TRANSFER, MUST BE LIMITED TO THOSE NECESSARY AND INCIDENTAL TO THE ADMINISTRATION OF THE REAL PROPERTY TAX LAW.

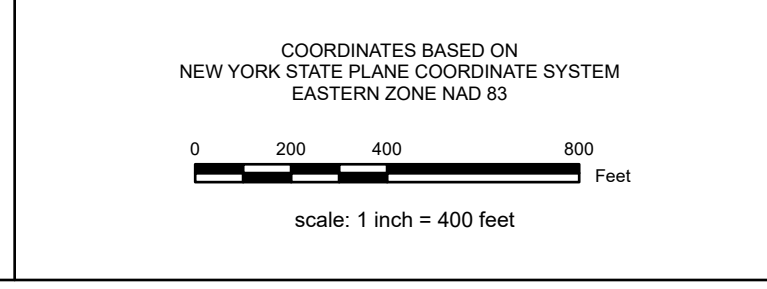

SPECIAL DISTRICTS	
SCHOOL: HADLEY LUZerne CENTRAL 52301	LIGHT:
FIRE: FIRE PROTECTION #2 F5042	PARK:
AG:	SEWER:
LAKE:	WATER:

PROPERTY LINE	GREAT LOT LINE	SCHOOL DISTRICT LINE
BLOCK LIMIT	SUBDIVISION LOT LINE	FIRE DISTRICT LINE
SECTION LIMIT	STATE ROUTE	WATER DISTRICT LINE
TOWN VILLAGE CITY	COUNTY ROUTE	AGRICULTURAL DISTRICT
COUNTY LINE	STREET OR TOWN ROAD	LIGHT DISTRICT
RAILROAD		NAD 83 TIC LINES

LEGEND	
GREAT LOT NUMBER	①
TAX MAP BLOCK NUMBER	⑨
FILED PLAN LOT NUMBER	⑨
TAX MAP PARCEL NUMBER	160.00-3-9
STREAMWATERBODY	
COORDINATE LOCATOR	+
DENOTES COMMON OWNER	

CALCULATED ACRES	
DEED ACRES	9.8 A (C)
SCALED DIMENSION	9.8 A
DEED DIMENSION	150.2
COORDINATE LOCATOR	+
DENOTES COMMON OWNER	

SHEET INDEX	
001.00	009.00
008.00	
015.00	016.00

TAX MAP **009.00**
TOWN OF DAY
SARATOGA COUNTY, NEW YORK
 TAXABLE STATUS DATE: March 1, 2028 MAP EXPORTED ON: March 17, 2028